

The 18th International Congress of Oriental Medicine 2016

第 18 回国際東洋医学会学術大会



**April 15(Fri)-17(Sun), 2016
Okinawa Convention Center
Ginowan, Okinawa, Japan**



SUN TEN 70th Anniversary



Authenticity Quality Experience Safety Consistency Transparency



東方医学を科学して70年、高品質の生薬への追求

Well-experienced in manufacturing of
Chinese herbal extract.

Dedicates in providing the best world
product quality.

<http://www.suntenglobal.com>
e-mail: marketing@suntan.com.tw
tel: +886-02-8978-5799



The 18th International Congress of Oriental Medicine 2016

第 18 回国際東洋医学会学術大会



April 15(Fri)-17(Sun), 2016

Date: (4-3-1 Mashiki, Ginowan

Venue: Okinawa Convention Center City Okinawa 901-2224, Japan)

TEL : +81(0)98-898-3000 /

FAX : +81(0)98-898-2202

Organizers: Japan Chapter of International Society of Oriental Medicine (ISOM)

Patronage: Japan Society for Oriental Medicine (JSOM)

Japan Society of Acupuncture and Moxibustion (JSAM)

Medical and Pharmaceutical Society for WAKAN-YAKU

Co-hosting: Japanese Society of Pharmacognosy (JSP)

CONTENTS

Welcome Address	
Dr. Keigo Nakata, President of International Society of Oriental Medicine (ISOM)	3
Dr. Shuji Ohno, The President of 18th ICOM	4
Dr. Hirofumi Tomori, Chairman of Executive Committee of the 18th ICOM	
Organizing Committee	5
Congress Information	6
Transportation	11
General Information for Poster Presenters	15
General Information for Invited Oral Presenters	16
Time Table	17
Program of the 18th ICOM	19
Lectures	19
Poster presentations	32
Author Index	59
List of Financial Sponsors	68

Welcome Remarks

As President of International Society of Oriental Medicine (ISOM), it is my great pleasure to hold 18th ICOM in Okinawa, in Japan with successfully. I am very glad to see colleagues in the world and to talk topics of traditional medicine each other.

And I have known highly efforts of the Organizing Committee of the Congress as well as the members of ISOM Japan Chapter, who have spent these two years making preparations for this highly refined congress. I would like to express my sincere thanks for them.

Successive ICOMs have boosted the exchange of academic information about Oriental medicine across the international borders year after year. This development has been spurred, in particular, by the emergence of young scientists, physicians, pharmacists, acupuncturists who are practicing traditional medicine. In addition, our chapters in Japan, South Korea and Taiwan have been strengthened structurally. All these relationships and friendships promise future development.

Natural medicines and the medicinal theory that had originated in ancient China land have spread throughout East Asia over a long period. And furthermore, those have evolved uniquely in each country and region to contribute the public health as their traditional medicine.

Our sincere hope is the traditional medicine will contribute more to the public health and the happiness of people throughout the world. We wish to achieve this by exchanging the useful information through this congress.

I wish to express my hope that this Society will continue to develop and grow traditional medicine in the future.



Dr. Keigo Nakata
President of International Society of Oriental Medicine (ISOM)

Welcome Address

The 18th International Congress of Oriental Medicine (ICOM) which based on the main topics "Integration of traditional and modern medicine" will be held in Okinawa where gentle wind blows from the beautiful sea. I am very pleased to welcome you to the ICOM. We are ready to invite many excellent researchers and clinicians from the world. I'm very much looking forward to seeing you in tropical island, and I am convinced that your participation make it become a fruitful congress.



Dr. Shuji Ohno,
The President of 18th ICOM

We have the great pleasure to invite all of you to the 18th International Congress of Oriental Medicine (ICOM) to be held in Okinawa, Japan. We also believe you will be able to enjoy Okinawa where there are many cultural and exciting places worth visiting, for example, Okinawa Churaumi Aquarium, Shuri Castle, Karate, Longevity meal, etc. We look forward to meeting and working with all of you at ICOM.



Dr. Hirofumi Tomori
Chairman of Organizing Committee of the 18th ICOM

Organizing Committee

President of the 18th ICOM

Shuji Ohno, M.D. Ph.D. (Director of Ohno Clinic)

Vice President of the 18th ICOM

Hiromichi Yasui, M.D. (President of Japan Chapter of ISOM, Director of Yasui Clinic)

Executive Adviser

Keigo Nakata, M.D. (President of ISOM, Director of Seikoen Hosono Clinic)

Chairman of the Executive Committee

Hirofumi Tomori, M.D. (Chief of Surgery Department, Naha City Hospital)

Chairman of Program Committee

Mosaburo Kainuma, M.D. Ph.D.
(Associate Professor, Community Medicine Education Unit,
Graduate School of Medical Sciences, Kyushu University)

Secretary General

Toshiaki Makino, Pharmacist, Ph.D. (Professor, Department of Pharmacognosy,
Graduate School of Pharmaceutical Sciences, Nagoya City University)

Committee Members All the names are listed in alphabetical order.

Masayuki Kashima, M.D. (Vice Director, Department of General Internal
Medicine, Japanese Red Cross Kumamoto Hospital)

Zuimei Miyazaki, M.D., Ph.D., FCCP, FASA
(Director of Miyazaki Clinic Shiohama Onmeikai)

Yoshiharu Motoo, M.D., Ph.D. FACP
(Professor, Department of Medical Oncology, Kanazawa Medical University)

Masanori Takashi, Pharmacist, L.Ac.
(Office of Acupuncture and moxibustion, Tokai University Oiso Hospital)

Rika Tawata, M.D. (Gynecologist of Naoko women's clinic)

Daisuke Watanabe, L.Ac., Ph.D. (Lecturer, Department of Acupuncture and
Moxibustion, Okinawa College of Integrative Medicine)

Hitoshi Yamashita, L.Ac., Ph.D. (Professor, Acupuncture Information Center
Morinomiya University of Medical Sciences)

Makoto Yoshitomi, M.D. (Director of Yoshitomi Fukuyoudou Clinic)

Adviser All the names are listed in alphabetical order.

Kenichi Takahashi, Ph.D. (President of Okinawa College of Integrative Medicine)

Yasuo Nakahara, M.D. (Director of Nakahara Kampo Clinic)

Cholsong Yang, M.D. (Director of Yan Herb Clinic)

Congress Information

1. Venue

Okinawa Convention Center

Conference Building A, Conference Building B, Conference Room C
4-3-1 Mashiki, Ginowan City Okinawa 901-2224, Japan
TEL: +81(0)98-898-3000 / FAX: +81(0)98-898-2202
URL: <http://www.oki-conven.jp/en/facilities/institution.html>

2. Web Page

<http://www.icom-okinawa2016.com>

3. Office

Corporate Games Japan Ltd.

1-12-17-1F, Kanagusuku, Naha 901-0155, Japan

TEL: +81(0)98-859-2580 / FAX: +81(0)98-859-2581

E-mail: 18thICOM@corporategames.jp

Japan Chapter of International Society of Oriental Medicine (ISOM)

Department of Pharmacogony, Graduate School of Pharmaceutical
Sciences, Nagoya City University

3-1, Tanabe-Dori, Mizuho-ku, Nagoya 4678603, Japan

TEL & FAX: +81(0)52-836-3416

E-mail: icom-japan@phar.nagoya-cu.ac.jp

4. Registration

Within the congress venue, please be sure to wear a name card.

Registration desk

April 15

13:30 to 16:30 pm at Okinawa Convention Center.

18:30 to 19:30 pm at Tubarama (とうばら一ま) in Naha City.

April 16

8:20 to 18:00 pm at Okinawa Convention Center.

April 17

8:20 to 15:00 pm at Okinawa Convention Center.

For the participants already registered by Web:

Please show us the registration number and your name at the counter.

If you are student, you must show your student ID at the front desk.

Registration on site:

Please write your personal information on the registration sheet, and pay 35,000 JPN for general or 6,000 for students at the registration desk.

Cash or credit card (VISA and Master card) is accepted.

General registration includes 'Welcome Party' and 'Gala Party' tickets.

5. General language

Except for Korea, Taiwan, Japan sessions, public lecture for Okinawa's citizens and pharmacists, please talk and discuss in English. For some special lectures conducted in Japanese, we will prepare consecutive interpreting into English.

Important Notice for making slides and posters

All slides and posters should be made in English. However, when you use traditional terms including the name of crude drugs, formulas, diagnosis, or physiology, etc. in Oriental Medicine, please use English or alphabetical terms ACCOMPANIED WITH (漢字, 汉字, Chinese or Japanese characters) in blanket.

Ex. Kidney deficiency (腎虚/肾虚), Tokishakuyakusan/Dangguishaoyaosan/
Danggwijagyagsan (当歸芍藥散/當歸芍藥散/当归芍药散).

It may be helpful for international communication in our society.

6. The First Japan-Germany Joint Symposium on Kampo Medicine and Acupuncture

This symposium is semi. closed event sponsored by Japan Chapter of International Society of Oriental Medicine (ISOM) from 14:00 to 18:00 on Friday, April 15, 2016 in Room A1 of Okinawa Convention Center. Registered attendants of the 18th ICOM can take part in this symposium freely as observers.

7. Welcome Party

Welcome party is held from 19:00 to 21:00 on April 15 at Tubarama (とぅばら一ま). To take part in the party, please show us the Welcome party ticket at the entrance. You can buy ticket on site with 7,000 JPY for general or 5,000 JPY for students.

Tubarama (とぅばら一ま)

URL: <http://tb.jcc.okinawa.net>

2. 7. 25, Makishi, Naha 9000013, Japan

TEL: +81(0)98. 862. 3124

Walk 3 min from Makishi (牧志) station (Yui Rail) along Kokusai. Dori (国際通り).

Walk 16 min from Kencho. mae (県庁前) station (Yui Rail) along Kokusai. Dori.

General Registration includes Welcome Party ticket but **NOT** any transportation fees from/to Welcome Party venue (Tubarama).

Participants of the First Japan. Germany Joint Symposium on Kampo Medicine and Acupuncture at Okinawa Convention Center are advised to make your way from to Tubarama on own by using public transportation.

Taxi: about 2,200 JPN for about 25 min. Get off at **Kokusain Dori near Makishi Station.**

Public bus: 480 JPN by No. 23. Get on the bus at 17:42 pm at Mashiki (真志喜) Bus Stop

(p. 11) and get off at 18:58 at Makishi (牧志) bus stop.

For Invited Speakers, Shuttle bus leaves from Convention Center at 18:15

to Kokusai. Dori, and leaves from Kokusai. dori at 21:15 to Laguna Garden Hotel on April 15. When the buses have vacant seats, general participants can get on buses.



Access from Makishi Station to Tubarama (とうばら一ま)

8. Gala Party

Please show us the ticket at the entrance.

18:00 to 20:30 on April 16 at Okinawa Convention Center Room A1

You can buy ticket at the registration desk with 7,000 JPY for general or 5,000 JPY for students.

9. Cloak

Cloak is open from 8:30 to 20:00 on April 16, and from 8:30 to 17:00 on April 17 at the registration desk in Okinawa Convention Center. Valuables can not be entrusted.

10. Calling

We can not call persons in all convention venues and rooms by announcement or slides.
You can use message board near the registration desk.

11. Luncheon Seminar

We will serve lunch box at Lunch on Seminar held on April 16 and 17 in Room A1. Please note that the number of lunch box is limited. The ticket of the seminar is served from 8:30 at the registration desk on each April 16 and 17. This ticket is limited to 1 ticket per person.

The serving will end when all the ticket has been served.

12. Okinawa Convention Center



Conference Building A

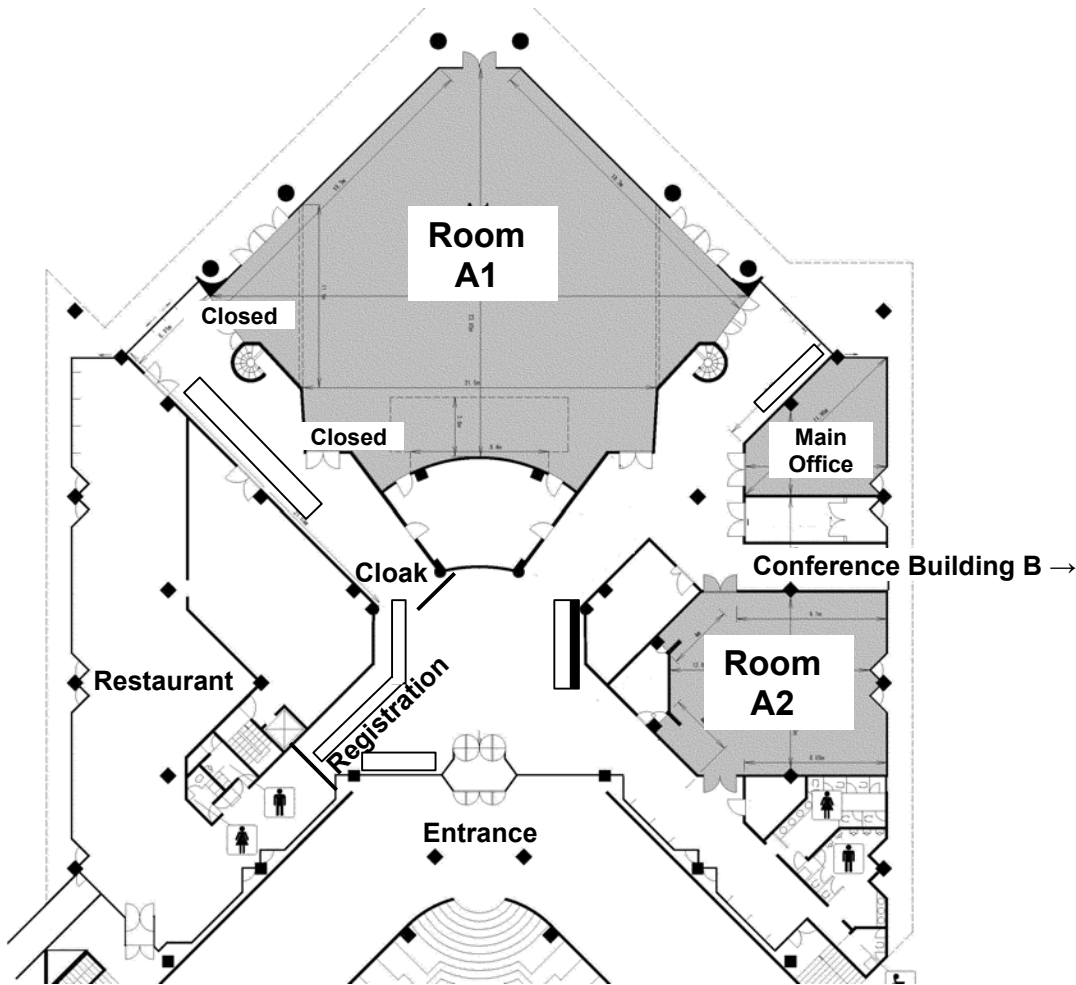

Conference Building B
1st Floor

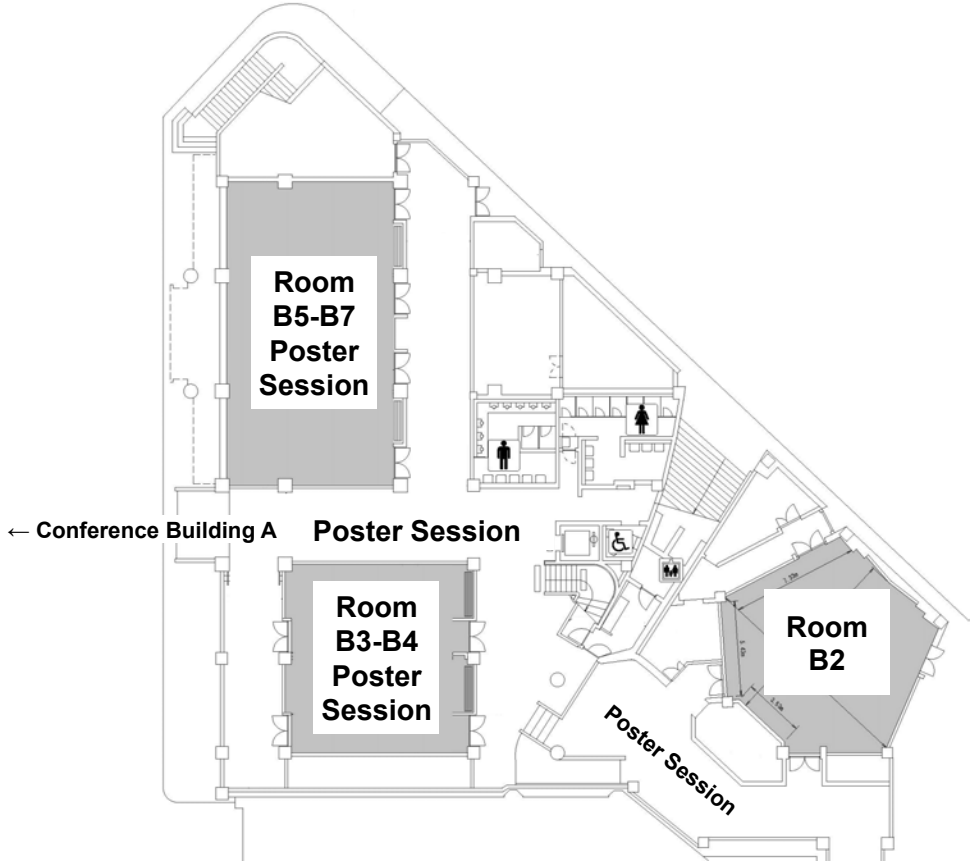

2nd Floor

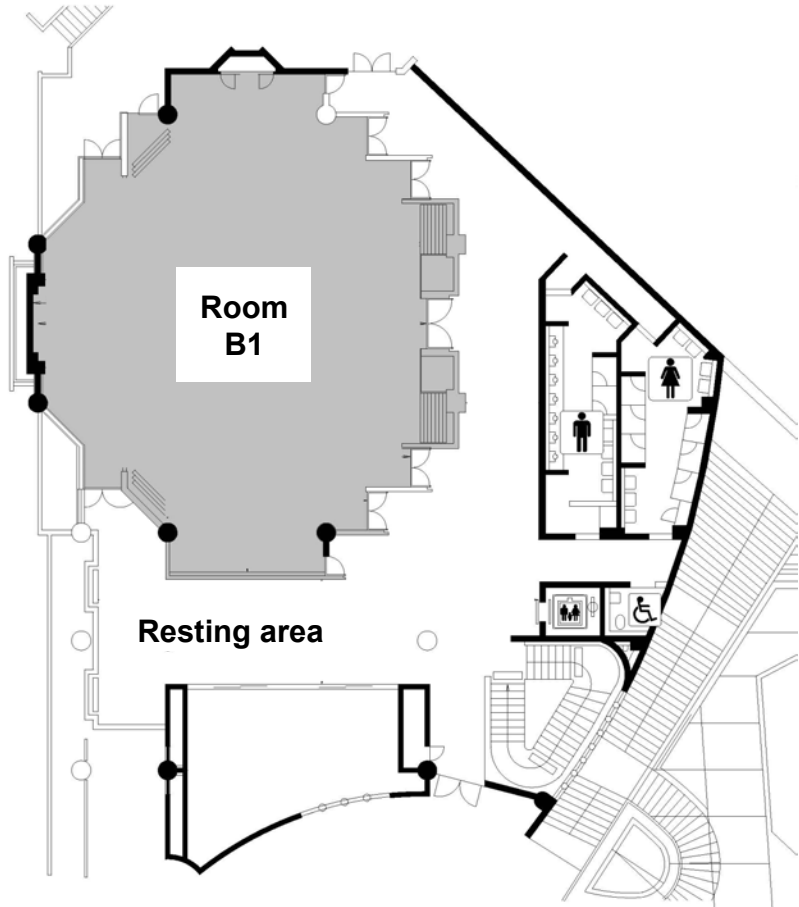

Conference Building C

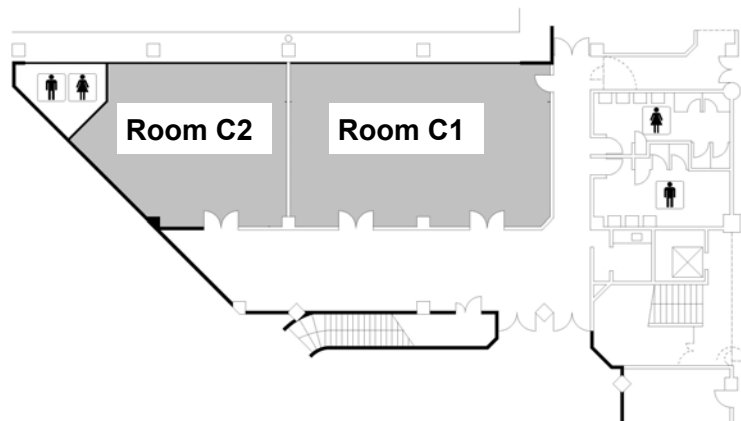

Transportation

Please check <http://www.oki-conven.jp/en/mapsanddirections.html>

To Okinawa:

Direct flight from most of cities in Japan, Taipei, Seoul, Busan, Shanghai, Beijing and Hong Kong.

From Okinawa Airport to the Venue

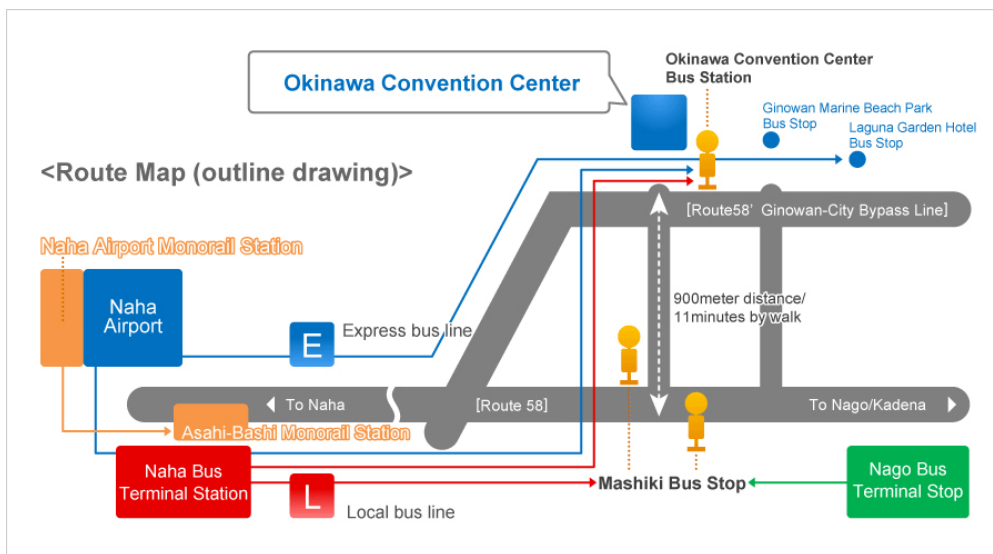

Bus

Route No 26 (50 minutes) or Route No 99 (70 minutes) from Naha International Airport (Bus Station No. 3) to Okinawa Convention Center Bus Stop. Fare: 570 JPN.

Time Table (Domestic Gate Bus Stop)

No. 26: Friday 15:10, Saturday and Sunday 10:25, 11:25, 12:55, 14:15, 15:45.

No. 99: Friday 12:10, 12:50, 13:35, 14:10, 14:50, 15:20, 15:50, 16:20

Saturday and Sunday 8:15, 9:00, 9:50, 10:35, 11:05, 11:40, 12:25, 13:05, 13:55, 14:35, 15:20, 15:55, 16:35

At at International Gate Bus stop, buses leave 1 - 2 min after the Domestic Gate Bus Stop.

Airport Limousine Bus

Limousine liner bus to Laguna Garden Hotel (40 min). Fare: 600 JPN.

*note: This limousine liner does not stop at the convention center, get off at Laguna Garden Hotel bus stop and walk to the center for 10 min.

Time Table: 11:35, 13:10, 16:00, 17:30 (Domestic); 11:37, 13:12, 16:02, 17:32 (International)

Taxi

About 40 minutes. Fare: about 3,000 JPN.

Vehicle / rental car

Takes about 40 minutes (14 km distance) from Naha Airport.

There's a possibility this information may be modified.

Rental Car is also available: <http://www.otsinternational.jp/otsrentacar/>

From Naha City to the Venue

From Naha Bus Terminal Station to the Okinawa Convention Center Bus Stop.

Route Number: No.26, No.32, No.55 (takes from 40 minute to 60 minutes)

Route Number: No.99 (takes 60 minute), No.112 (takes 50 minute). Fare: 530 JPN.

No. 26 (Asahibashi): Friday 15:20, Saturday and Sunday 10:34, 11:34, 13:05, 14:25, 15:55.

No. 32 (Naha Bus Terminal): Friday and Saturday 7:22, 7:44, 8:20, 9:02, 9:37, 9:52, 10:52, 11:28, 11:52, 13:07, 13:52, 14:58

Sunday 7:32, 7:57, 8:21, 8:47, 9:12, 9:32,

No. 55 (Asahibashi): Friday 11:17, 11:52, 12:17, 12:47, 13:12, 13:47, 14:12, 14:48, 15:23

Saturday and Sunday 7:33, 8:06, 8:43, 9:17, 9:56, 10:30, 11:10, 11:45
12:25, 13:00, 13:45, 14:28, 15:15, 15:56, 16:38

No. 99 (Asahibashi): Friday 11:35, 12:20, 13:00, 13:45, 14:20, 15:00, 15:30, 16:00

Saturday and Sunday 7:10, 7:40, 8:24, 9:09, 9:59, 10:44, 11:14, 11:49,
12:34, 13:15, 14:05, 14:45, 15:30, 16:05

No. 112 (Naha Bus Terminal): Friday 10:20, 15:50, 16:35.

Saturday and Sunday 6:45, 9:05, 15:50

From Naha Bus Terminal Station to the Mashiki (真志喜) Bus Stop

Route Number: No.20, No.77, No.120 (takes from 45 minute)

Route Number: No.23, No.28, No.29, No.63 (takes from 35 minute)

Route Number: No.31 (takes from 50 minute). Fare: 530 JPN.

No. 20 (Naha Bus Terminal): Friday, 7:15, 7:42, 8:15, Saturday and Sunday 7:15, 7:42, 8:15

No. 23 (Naha Bus Terminal): Friday 11:30, 11:50, 12:23, 12:36, 13:05, 13:24, 13:48, 14:15, 14:28, 14:54, 15:20, 15:32, 15:44, 15:56, 16:20. Saturday and Sunday, 7:45, 8:05, 8:25, 9:05, 9:45, 10:25, 11:05, 11:20, 12:10, 12:35, 13:15, 14:15, 14:35, 15:20, 15:45

No. 28 (Naha Bus Terminal): Friday 12:00, 12:17, 12:27, 12:52, 13:07, 13:17, 14:07, 14:22, 14:32, 15:02, 15:17, 15:27, 15:39, 16:05. Saturday and Sunday 7:30, 7:45, 8:55, 9:20, 10:00, 10:20, 11:30, 12:10, 12:47, 13:05, 14:10, 14:50, 15:05, 15:30, 15:45, 16:50

No. 29 (Naha Bus Terminal): Friday 12:07, 16:35, 17:27, 18:20. Saturday and Sunday 7:17, 11:50, 13:50, 16:15

No. 31 (Naha Bus Terminal): Friday 11:40, 12:05, 12:30, 12:55, 13:20, 13:45, 14:10, 14:35, Saturday, 7:30, 8:00, 8:30, 9:00, 9:30, 9:55, 10:10, 10:30, 11:00, 11:25, 11:50, 12:20, 12:50, 13:20, 13:55, 14:25, 14:50, 15:10, 15:30, 15:50
Sunday, from 7 to 15, every hour, 05 and 35 min.

No. 63 (Naha Bus Terminal): Friday 12:10, 13:20, 14:00, 14:45.
Saturday and Sunday 8:50, 9:20, 10:00, 10:40, 11:30, 13:10, 13:55,

No. 77 (Naha Bus Terminal): Friday and Saturday 7:20, 8:55, 9:20, 10:25, 12:40, 13:10, 13:45, 14:25.
Sunday 7:40, 8:20, 9:00, 9:35, 10:55, 11:35,

No. 120 (Asahibashi): Friday and Saturday, 8:57, 9:17, 9:37, 10:02, 10:22, 10:47, 11:12, 11:42, 12:12, 12:42, 13:12, 13:42, 14:12, 14:42, 15:12, 15:42
Sunday 8:57, 9:17, 9:37, 10:02, 10:22, 10:47, 11:12, 11:42

From the Venue to Naha City

From Okinawa Convention Center Bus Stop to Naha Bus Terminal Station.

No. 26: Friday 16:54, Saturday and Sunday 14:22, 15:42, 17:17, 18:37.

No. 32: Friday and Saturday 13:57, 14:42, 15:27, 16:07, 16:57.
Sunday 11:22, 12:27, 13:52, 15:02, 16:12, 17:37, 18:37, 19:57.

No. 55: Friday 14:18, 14:48, 15:18, 15:53, 16:28, 17:05, 17:40, 18:15.
Saturday and Sunday 11:17, 11:57, 12:32, 13:17, 13:57, 14:42, 15:22, 16:02, 16:47, 17:32, 18:12, 19:02, 20:07, 21:02.

No. 99: Friday 14:38, 15:18, 15:58, 16:33, 17:10, 17:45, 18:20.
Saturday and Sunday 11:12, 11:57, 12:32, 13:17, 14:02, 14:42, 15:22, 16:07, 16:52, 17:32, 18:12, 18:57, 19:42.

No. 112 (Naha Bus Terminal): Friday 16:23, 17:04, 17:28.
Saturday and Sunday 10:18, 16:16 19:54.

From the Mashiki (真志喜) Bus Stop to Naha Bus Terminal Station

Route Number: No.20, No.77, (takes from 45 minute)

Route Number: No.120 (60 min)

Route Number: No.23, No.28, No.29, No.63 (takes from 35 minutes to 45 min)

Route Number: No.31 (takes from 50 min) Fare: 530 JPN.

Time Table

No. 20: Friday, 19:45, 20:12, 20:57, 21:40, Saturday and Sunday 19:44, 20:11, 20:56, 21:39

No. 23: Friday, 14:40, 14:53, 15:19, 15:31, 15:57, 16:09, 16:27, 16:38, 16:49, 17:00, 17:16, 17:26, 17:38, 17:54, 18:07, 18:53
Saturday and Sunday, 11:11, 12:01, 12:52, 13:18, 14:11, 14:41, 15:31, 15:46, 16:01, 16:17, 16:32, 16:47, 17:04, 17:23, 18:03, 18:48, 19:11, 19:39, 20:04, 20:28, 20:51, 21:14, 21:38

No. 28: Friday 14:08, 14:23, 14:43, 15:29, 15:39, 15:55, 16:05, 16:17, 17:23, 17:37, 17:48, 18:02, 18:25
 Saturday and Sunday 13:10, 13:25, 14:00, 14:15, 14:54, 15:07, 15:56, 16:57, 17:39, 18:04, 18:29, 19:08, 19:26, 19:47, 20:04, 20:33, 21:13, 21:38

No. 29: Friday 11:25, 13:38, 16:50. Saturday and Sunday 16:09

No. 31: Friday 14:52, 15:15, 15:35, 15:54, 16:14, 16:34, 17:03, 17:18, 17:43, 18:01, 18:24
 Saturday, 12:22, 12:59, 13:29, 13:59, 14:34, 15:11, 15:35, 16:03, 16:28, 16:51, 17:16, 17:42, 18:07, 18:28, 18:53, 19:26, 19:56, 20:26, 20:51, 21:17
 Sunday, 13:04, 13:35, 14:05, 14:35, 15:06, 15:35, 16:05, 16:35, 17:05, 17:36, 18:06, 18:37, 19:07, 19:37

No. 63: Friday 11:45, 13:06, 14:51, 15:33, 17:50.
 Saturday and Sunday 14:47, 15:32, 17:27, 18:15, 19:03, 20:09, 20:56

No. 77: Friday 11:27, 13:31, 15:01, 16:50, 18:52.
 Saturday 11:27, 13:31, 14:57, 16:44, 18:41. Sunday (via Kumoji) 11:45, 12:20, 13:00, 13:35, 14:29, 15:04, 16:20, 17:06

No. 120: Friday, 14:39, 15:09, 15:44, 16:17, 16:47, 17:17, 17:46, 18:19.
 Saturday and Sunday, 12:01, 12:31, 13:07, 13:37, 14:09, 14:39, 15:09, 15:43, 16:16, 16:46, 17:16, 17:46, 18:16, 18:46, 19:14

From the Venue to Okinawa Airport

Route No 26 (55 min) or Route No 99 (70 min).

Fare: 570 JPN.

Time Table at Okinawa Convention Center Bus Stop.

No. 26: Saturday and Sunday 14:22, 15:42, 17:17, 18:37.

No. 99: Saturday and Sunday 14:02, 14:42, 15:22, 16:07, 16:52, 17:32, 18:12, 18:57, 19:42,

Airport Limousine Bus

Limousine liner bus from Laguna Garden Hotel (40 min). Fare: 600 JPN.

Time Table at Laguna Garden Hotel: 11:43, 14:28, 15:58

※Bus time table may be changed at April 1, 2016. Please check at the bus stop.

※Okinawa Bus map is shown at http://www.kotsu-okinawa.org/en/map_south.html

General Information for Poster Presenters

Poster Specifications:

Each poster presenter will be provided with a surface on which to mount the poster. Each poster must be within 1918 mm height and 935 mm width. Please drop your poster number at the upper left area (about 15 cm x 15 cm). Supplies to hang posters will be available to you onsite (push pins).

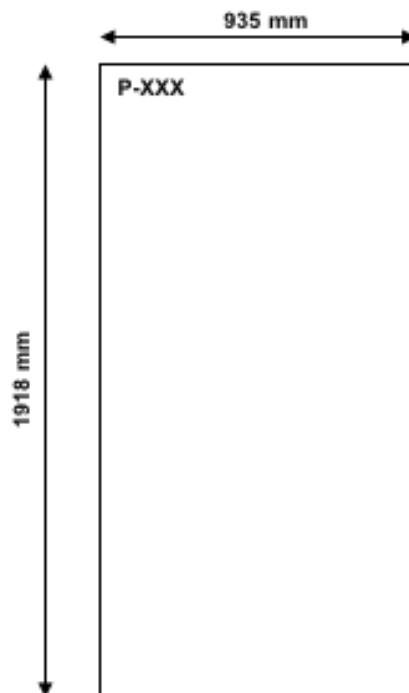

Poster Sessions Schedule:

All posters will be set up at Conference Building B at Okinawa Convention Center. Presenters **MUST** stand in front of their posters during scheduled poster session to discuss with participants. There are no chairpersons in scheduled poster sessions, and you can talk with participants freely.

There will be two separate Poster Session as follows:

- For those who has ODD poster numbers: from 17:00 - 17:30 on April 16.
- For those who has EVEN poster numbers: from 17:30 – 18:00 on April 16.

Set-Up:

Each poster can be set up any time from 8:30 to 10:00 on April 16, and kept it by 14:00 on April 17. You can remove posters after 14:00 on April 17.

Note: If you do not remove your poster after 17:30 on April 17, your poster will be discarded.

Poster Board:

You will be asked to set up your poster on the assigned board as indicated by Assignment Board which will be shown on congress day at Conference Building B.

Important Notice for making poster:

All posters should be made in English. However, when you use traditional terms including the name of crude drugs, formulas, diagnosis, or physiology, etc. in Oriental Medicine, please use English or alphabetical terms ACCOMPANIED WITH (漢字, 汉字, Chinese or Japanese characters) in blanket.

Ex. Kidney deficiency (腎虚/肾虚), Tokishakuyakusan/Dangguishaoyaosan/
Danggwijagyagsan (当歸芍藥散/當歸芍藥散/当归芍药散).

It may be helpful for international communication in our society.

Award of Poster Presentation:

The Poster Award is awarded to the author of meritorious poster presentations in the congress. The Awards will be presented at the Farewell Ceremony.

General Information for Invited Oral Presenters

Digital projector:

Organizing Committee will prepare note-type PC computer installed with Windows 7 and PowerPoint 2010 that are connecting to digital projector to conduct the presentation.

If you would like to use our computer, please bring PowerPoint data in USB memory at the congress.

If you would like to use your computer, you can connect to our digital projector via three-row 15-pin DE-15 VGA connector.

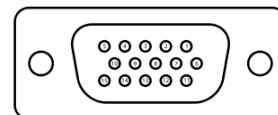

In Japan the standard voltage and frequency is 100 V and 60 Hz. The power sockets that are used are of type A. Please prepare the power sockets and corresponding plugs.



At least 1 hr before your presentation (in rest hours), please check-in at the operation desk near the stage in conference room.

Important Notice for making slide shows:

All slides should be made in English. However, when you use traditional terms including the name of crude drugs, formulas, diagnosis, or physiology, etc. in Oriental Medicine, please use English or alphabetical terms ACCOMPANIED WITH (漢字, 汉字, Chinese or Japanese characters) in blanket.

Ex. Kidney deficiency (腎虚/肾虚), Tokishakuyakusan/Dangguishaoyaosan/
Danggwijagyagsan (当歸芍藥散/當歸芍藥散/当归芍药散).

It may be helpful for international communication in our society.

Time Table

April 15, 2016

14:00 - 18:00, Room A1

The First Japan. Germany Joint Symposium on Kampo Medicine and Acupuncture

19:00 - 21:00, at Tubarama (とうばら一ま)

Welcome Party

April 16, 2016

		A1	B1	A2	B2	B3-B7	C1	
A M	9	Invited Lecture 1 Dr. Kunxing Yan						
	10	Accupuncture Symposium Dr. Hitoshi Yamashita Dr. Benjamin Chant	Education Lecture 1 Dr. Klaus Hambrecht	Korea Session (Sasang Constitutional Medicine Symposium) Dr. Do Young Choi Dr. In-Tae Kim		Poster exhibition	The Toumonkai Special Session in Okinawa (In Japanese and Chinese)	
	11		Education Lecture 2 Dr. Heidrun Reißwieser-Hewel					
			Education Lecture 3 Dr. Ulrich Eberhard					
12	Luncheon Seminar Prof. Akio Inui							
P M	1	Pharmaceutical Symposium Prof. Toshiaki Makino Prof. Ching-Chiung Wang	Education Lecture 4 Dr. Bernd Kostner	Korea Session (Korea-Japan Oriental Medical Symposium) Dr. Do Young Choi Dr. Young-shin Kim Dr. Yoshitomi Makoto (In Korean and Japanese)	Taiwan Session Special Lecture Dr. Lin, Jaung Geng			
	2		Education Lecture 5 Dr. Joon-Seok Byun					Taiwan Session Dr. Lin, Jaung Geng Dr. Chen, Jing-Ming (In Chinese)
			Education Lecture 6 Dr. In-Tae Kim					
	3				General Lecture 1 Dr. Eric Brand			
	4		General Lecture 2 Dr. Shin Takayama	Education lectures for the local pharmacists (in Japanese) Prof. Katsunori Nakamura Prof. Toshiaki Makino				
	5		General Lecture 3 Prof. Toshinori Ito		Poster presentation			
	6	Gala Party						

April 17, 2016

		A1	B1	A2	B3-B7	
A M	9	President Lecture Dr. Shuji Ohno	Japan Session Medical Symposium 2 Dr. Keisuke Hagihara Dr. Hideyuki Nakata (In Japanese)		Poster exhibition	
	10	Invited Lecture 2 Dr. Gary Deng				
	11	Invited Lecture 3 Dr. Hyejung Lee				
P M	12	Luncheon Seminar Dr. Sven Schröder				Education Lecture 7 Prof. Jung-Nien Lai
	1	Special Lecture Dr. Hiroshi Sato				Education Lecture 8 Dr. Wen-Fed Chiou
	2	Medical Symposium Dr. Silke Cameron Dr. Shin Takayama				Education Lecture 9 Prof. Yasuyuki Hirose
	3		Public Open Lectures (in Japanese)			Education Lecture 10 Dr. Hans Rausch
	4		Invited Lecture 4 Dr. Fumino Ninomiya			
		Farewell				

Program of the 18th ICOM

Friday, Apr 15, 2016

Room A1

The First Japan-Germany Joint Symposium on Kampo Medicine and Acupuncture

(This event is semi-closed, and the participant of 18th ICOM can attend as observer)

**(Sponsored by International Society of Oriental Medicine (ISOM) Japan Chapter
and Goto College of Medical Arts and Sciences)**

Participants: 8 persons from Germany and German-speaking countries;

Approximately 20 persons from Japan, as well as some observers from USA, etc.

Anchorpersons: Yoshiharu Motoo, Heidrun Reissenweber-Hewel

Opening remarks: Yoshiharu Motoo & Heidrun Reissenweber-Hewel

Session 1. Structure and characteristics of Kampo Medicine

Chair: Klaus Hambrecht

Speaker: Masayuki Kashima (30 min)

Commentator 1: Ulrich Eberhard

Commentator 2: Bernd Kostner

Discussion (30 min)

Break (8 min)

Session 2. Concept on active ingredients of crude drugs used in Kampo Medicine

Chair: Sven Schroeder

Speaker: Toshiaki Makino (30 min)

Commentator 1: Silke Cameron

Commentator 2: Kenny Kuchta

Commentator 3: Hans Rausch

Discussion (30 min)

Break (8 min)

Session 3. Clinical trial on acupuncture

Chair: Den'ichiro Yamaoka

Speaker: Claudia Witt (30 min)

Commentator 1: Hitoshi Yamashita

Commentator 2: Takashi Seki

Discussion (30 min)

Closing remarks: Yoshiharu Motoo & Heidrun Reissenweber-Hewel

Saturday, Apr 16, 2016

Room A1

8:50 – 9:00 Opening Address

9:00 – 9:55 Invited Lecture 1

Chair: Tetsuo Akiba, Japan (Akiba Clinic, Japan)

IL-1 Dr. Yen's Kampo Medicine: Survey of Traditional Chinese Medicine in Diagrams and Tables

顏 焜榮 / Kun-Ying Yen (Taipei Medical University, Taiwan)

10:00 – 11:55 Acupuncture Symposium

(Sponsored by SEIRIN CORPORATION)

Chairs: Hitoshi Yamashita (Morinomiya Univ. of Medical Sci., Japan)
and Benjamin Chant (Australia)

S1-1 Moxibustion Treatment in Korea

Dongwoo Nam (Kyunghee University, Korea)

S1-2 The effects of moxibustion on the obese adolescent girls – Taiwanese experience

Tse-Hung Huang (Taiwan)

S1-3 Modern clinical application of moxibustion rooted in the local community: Ehime Prefectural Central Hospital's policy and methods

Akio Manabe (Ehime Prefectural Central Hospital, Japan)

S1-4 An Australian acupuncturist's perspective of moxibustion practice in East Asian countries

Benjamin Chant (Univ. New England, Armidale, Australia)

12:05 – 13:00 Luncheon Seminar 1 (Sponsored by TUMURA & CO.)

Chair: Mosaburo Kainuma (Kyusyu Univ., Japan)

LS-1 Anorexia - cachexia syndrome and Kampo medicine

Akio Inui (Kagoshima Univ., Japan)

13:05 – 15:00 Pharmaceutical Symposium

(Sponsored by Kobayashi Pharmaceutical Co., Ltd.)

Chairs: Toshiaki Makino (Nagoya City Univ., Japan)
and Ching-Chiung Wang (Taipei Medical Univ., Taiwan)

- S2-1 Anti-allergic effect of Shoseiryuto (小青竜湯) and Byakkokakeishito (白虎加桂枝湯) and the roles of each components – the roles of peony root (芍藥) and gypsum (石膏) in these formulas**
Toshiaki Makino (Nagoya City Univ., Japan)
- S2-2 The prescription philosophy of Dun Huon Ji-ShengTang (獨活寄生湯) for the prevention of arthritis**
Ching-Chiung Wang (Taipei Medical Univ., Taiwan)
- S2-3 Comparison of the improvement effects of nonalcoholic fatty liver disease of Gangjihwan (降脂丸) extracts by solvents in a high fat diet-fed obese C57BL/6 mouse model**
Soon Shik Shin (Dong-Eui University, Republic of Korea)
- S2-4 Chinmedomics strategy for research of effective substance basis and synergistic properties of Yinchenhao-Tang (茵陳蒿湯)**
Xijun Wang (Heilongjian TCM Univ., China)

**18:00 –
Gala Party**

Room B1

10:15 – 10:45 Education Lecture 1

Chair: Yoshiharu Motoo (Kanazawa Medical Univ., Japan)

EL-1 Development of acupuncture in Germany reflected by the Societas Medicinae Sinensis (SMS) and German Medical Acupuncture Association (DÄGfA)

Klaus Hambrecht (Clinic for Chinese Medicine, Germany)

10:50 – 11:20 Education Lecture 2

Chair: Kenji Watanabe (Keio Univ., Japan)

EL-2 Kampo international: Activities of the International Society for Japanese Kampo Medicine (ISJKM) and Kampo teaching for doctors in Germany

Heidrun Reißerweber-Hewel (Technical Univ. of Munich, Germany)

11:25 – 11:55 Education Lecture 3

Chair: Kenji Watanabe (Keio Univ., Japan)

EL-3 Phytotherapy in Europe

Kenny Kuchta (National Institute of Health Sciences, Japan)

13:05 – 13:35 Education Lecture 4

Chair: Keiko Ogawa (Kanazawa Univ., Japan)

EL-4 Insights from teaching Kampo medicine in Austria

Bernd Kostner (Zentrum für Ganzheitliche Medizi, Austria)

13:40 – 14:10 Education Lecture 5

Chair: Chan Y.L. Abraham (Purapharm Int., HongKong)

EL-5 Current state and development of traditional Korean medicine

Joon-Seok Byun (Daegu Haany Univ., Korea)

14:15 – 14:45 Education Lecture 6

Chair: Chan V.K. Abraham (Purapharm Int., Hong Kong)

EL-6 The role of the complementary medicine in cancer treatment – Including the Korean medicine

In-Tae Kim (Jangdeuk Korean Medical Hospital, Korea)

15:05 – 16:00 General Lecture 1

Chair: Masayoshi Oyama (Gifu Pharmaceutical Univ., Japan)

GL-1 The value of collections in clarifying historical changes in Chinese herbal medicine

Eric Brand (Hong Kong Baptist University, Hong Kong)

16:00 – 16:55 General Lecture 2 (Sponsored by OMINEDO PHARMACUTICAL Co. Ltd.)

Chair: Silke Cameron (Germany)

GL-2 Japanese Kampo medicine after the great east Japan earthquake in Miyagi and Fukushima prefectures

The role of Kampo medicine after the great east Japan earthquake disaster
Shin Takayama (Tohoku Univ., Japan)

A randomized controlled trial using Kampo medicine, saikokeishikankyoto (柴胡桂枝乾姜湯) on posttraumatic stress disorder developed after the great east Japan earthquake and tsunami
Takehiro Numata (Tohoku Univ., Japan)

16:55 – 17:50 General Lecture 3

Chair: Dr. Takao Namiki (Chiba Univ., Japan)

GL-3 Present status and perspective of integrative medicine in Japan

Toshinori Ito (Osaka Univ., Japan)

Room A2

Korea Session

10:00 – 12:00 Sasang constitutional medicine symposium (Talk in English)

Chairs: Ho Soon Kim / 金鎬順 (ISOM Director / 國際東洋醫學會, Korea)

In Tae Kim / 金仁泰 (ISOM Director / 國際東洋醫學會, Korea)

KS-1 Genomic analyses on constitutional type-related traits in Korean medicine

Seongwon Cha / 車誠原

(Korea Institute of Oriental Medicine (KIOM) / 韓國韓医学研究院, Korea)

KS-2 Researches on Sasang constitutional medicine (SCM) in Korea: trend and challenges

Sang-Hyuk Kim / 金相赫

(Korea Institute of Oriental Medicine (KIOM) / 韓國韓医学研究院, Korea)

KS-3 The future of the Japanese constitution of Sasang constitutional medicine

Akiko Hirota / 廣田曄子 (Aki Clinic / 曄小児科内科)

13:00 – 16:00 Korea-Japan Oriental medical symposium

(Talk in Korean and Japanese)

Chairs: Do Young Choi / 崔道永 (Kyung Hee Univ. / 慶熙大学校, Korea)

Young-Shin Kim / 金英信 (Korea Society of Oriental Medicine / 韓國東洋医学会, Korea)

Yoshitomi Makoto / 吉富誠 (Fukuyoudou Clinic / 吉富復陽堂医院, Japan)

KS-4 History of Japan-Korea Oriental medicine cooperation / 日韓漢方交流の歴史

Yoshitomi Makoto / 吉富誠 (Fukuyoudou Clinic / 吉富復陽堂医院, Japan)

KS-5 Acupuncture for smoking cessation in Korea / 韓国の禁煙鍼

Do Young Choi / 崔道永 (Kyung Hee Univ. / 慶熙大学校, Korea)

KS-6 Thread-embedding therapy of Korea / 韓国の埋線療法

Hyun-Jong Lee / 李沄宗 (Daegu Haany Univ. / 大邱韓醫大學校, Korea)

KS-7 The truth of Shanghanlun (傷寒論) and its actual clinical application / 傷寒論の真実と臨床応用の実際

Young-Beom Rho / 盧永範 (Korean Medical Association of Clinical Sanghan-Geumgwe / 大韓傷寒金匱医学会)

薬剤師向け漢方講座（日本語）

／Lectures for the pharmacists in Okinawa (in Japanese)

(Sponsored by Japan Kanpo Society)

16:10 – 17:00

Chair: Toshiaki Makino (Nagoya City Univ., Japan) / 牧野利明（名古屋市大薬学研究科）

PL--1 Drug interactions among functional foods, crude drugs, kampo medicines and Western medicines / 生薬・漢方薬・機能性食品と医薬品の薬物相互作用について
Katsunori Nakamura (Univ. Ryukyu, Japan) / 中村克徳（琉球大学附属病院薬剤部）

17:00 – 17:50

Chair: Katsunori Nakamura (Univ. Ryukyu, Japan) / 中村克徳（琉球大学附属病院薬剤部）

PL--2 The characteristics of Kampo granule prescription and medication counseling
/ 漢方エキス製剤の特徴を知り、服薬指導に生かす
Toshiaki Makino (Nagoya City Univ., Japan) / 牧野利明（名古屋市大薬学研究科）

The 18th ICOM, OKINAWA のご盛会を

お祝い申し上げます。

厳選した生薬と伝統の製剤技術

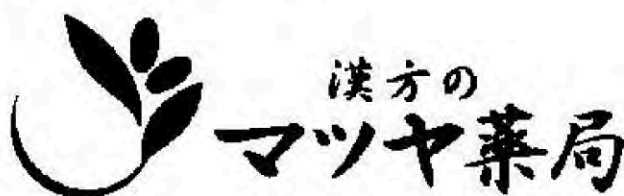

〒953-0041 新潟市西蒲区巻甲 2927-5

Tel/Fax (0256) 72-2132 E mail: fueki@cocoa.ocn.ne.jp

Room B2

Taiwan Session

13:00 – 13:55 Special Lecture in Taiwan Session

Chair: Chieh. Fu Chen (National Yang. Ming Univ., Taiwan)

TS-S Evidencen based medicine in acupuncture analgesia (talk in English)

Lin, Jaung Geng (China Medical Univ., Taiwan)

14:00 – 17:00 Taiwan Session

Chair: Lin, Jaung Geng / 林昭庚 (China Medical Univ., Taiwan)
and Chen, Jing-Ming / 陳俊明 (National Union of Chinese Medical
Doctors' Association, Taiwan)

TS-1 The assessment of traditional Chinese medicine on the risk of dementia in stroke patients / 中醫藥治療對預防中風病人失智症之療效評估 (talk in English)

Shih, Chun Chuan / 施純全 (Associate Professor, I-Shou Univ., Taiwan)

TS-2 Traditional Chinese Medicine Treatment for acne / 痤瘡中醫療法及治療經驗 (talk with English)

Chen, Chao Tsung / 陳潮宗 (President, Taiwan Society of Chinese Medical
Cosmetology, Taiwan)

TS-3 Misdiagnosed menopause symptoms / 易被誤診的停經症候群 (talk in Chinese)

Chen, Jing Ming / 陳俊明 (Vice President, National Union of Chinese Medical
Doctors' Association, Taiwan)

TS-4 Therapeutic experience on facial nerve palsy / 顏面神經麻痺之治療經驗 (talk in Chinese)

Li, Fong Yu / 李豐裕 (Vice President, National Union of Chinese Medical Doctors'
Association, Taiwan)

TS-5 The clinical application of Qingn Shangn Juann Tong- ang in the treatment of headache / 清上蠲通湯治療頭痛的臨床應用 (talk in Chinese)

Chen, Chih-Fang / 陳志芳 (President, Taiwan Society of Chinese Medicine
Andrology, Taiwan)

TS-6 WEN's acupuncture : Modulation autonomic nervous of system / 溫氏直刺自律神經調控法 (talk in Chinese)

Wen, Tsung-Kai / 溫崇凱 (President, Taiwan Clinical Chinese Medicine Association,
Taiwan)

Room C1

The Toumonkai 藤門会 Special Session in Okinawa

with Dr. Shou 鍾先生 and Dr. Tei 鄭先生 from Taiwan

(Talk in Chinese and Japanese)

The Symposium On Jyoukitou 「承氣湯類」 and related prescription

Chair: Takao Namiki / 並木隆雄 (Chiba Univ., Japan / 千葉大学)

12:00 – 12:40

TM-1 The study of the pathology of “shitimotsukoubokutousyou (七物厚朴湯証)” / 七物厚朴湯証の病態考察

Yoshihiro Fukuta / 福田佳弘 (Fukuta Orthopedic Clinic, Japan / 福田整形外科医院)

12:45 – 13:30

TM-2 Tiao Wei Cheng Qi Tang (調胃承氣湯) for the treatment of Immune thrombocytopenic Purpura (ITP) / 以調胃承氣湯治療原發性紫斑症

Chung Chen li / 鍾箴禮 (Ching Shiang Chinese Medicine Clinic, Taiwan / 慶祥中医診所)

13:40 – 14:20

TM-3 A secondary amenorrhea woman had led to get pregnant and safety delivery by a long-term(including 14 months before her pregnancy and the whole gestation period) continuous medication of Dai-Joki-to (大承氣湯) combined with Dai-Saiko-to (大柴胡湯) : We take the clinicopathologic difference between Dai-Joki-to and Dai-Saiko-to into consideration in order to discriminate their peculiarities by this effective case study and referring to Chinese medical classics to verify it. / 大承氣湯合大柴胡湯の長期（妊娠 14 ヶ月前から妊娠の全期間）投与による妊娠・出産に至った二次性無月経の一例 ～ 症例と古典より、大承氣湯と大柴胡湯の病態異同を検討～

Chiensho Lai / 賴建守 (Kampo Medical Lai Clinic, Japan / 漢方医療 賴クリニック)

14:25 – 15:05

TM-4 Compare with the three types of Chenqi Tang (承氣湯) described in the “Shang Han Lun(傷寒論)” and clinic use, with Huanglian Tang(黃連湯) to treat colon cancer stage 4 / 由三承氣湯的古典條文分析比較與臨床運用，合黃連湯治療大腸癌末期病例

Hung Tsu Cheng / 鄭宏足 (Life Care Classic Chinese Medicine / 傳愛經典中医診所)

15:10 – 15:25

TM-5 The Kampo medicine jokin to (承氣湯) and the intestinal immune system / 漢方薬と腸管での免疫—承氣湯との関係

Takao Namiki / 並木隆雄, Yoshiro Hirasaki / 平崎能郎
(Chiba Univ., Japan / 千葉大学)

15:30 – 16:00 General Discussion

Sunday, Apr 17, 2016

Room A1

9:00 – 9:55 President Lecture

Chair: Lee Eungse (Secretary General of ISOM, Korea)

PL The role of Kampo medicine in treating rheumatic diseases

Shuji Ohno (Ohno Clinic, Japan)

10:00 – 10:55 Invited Lecture 2

Chair: Shuji Ohno (Ohno Clinic, Japan)

IL-2 Integration of Oriental medicine into medical care of cancer patients in the US

Gary Deng (Memorial Sloan-Kettering Cancer Center, USA)

11:00 – 11:55 Invited Lecture 3

Chair: Claudia Witt (Univ. of Zurich, Switzerland)

IL-3 Challenges and opportunities in the advancement of Korean medicines

Lee Hyejung (President, Korea Institute of Oriental Medicine [KIOM], Korea)

12:05 – 13:00 Luncheon Seminar 2

(Sponsored by KOTARO PHARMACEUTICAL CO., LTD., Kracie
Pharmaceutical Co., Ltd., and OHSUGI Pharmaceutical Co., Ltd.)

Chair:
Hiromichi Yasui (Yasui Clinic, Japan)

**LS-2 Immediate pain relief by acupuncture. Randomized placebo controlled studies
with press tack needles**

Sven Schröder (Univ. Medical Center Hamburg-Eppendorf, Germany)

13:05 – 14:00 Special Lecture

Chair: Keigo Nakata (President of ISOM, Japan)

SL-1 Japan Society for Oriental Medicine (JSOM): History and prospects

Hiroshi Sato (Japan Society for Oriental Medicine, Japan)

14:05 – 16:00 Medical Symposium

(Sponsored by Kracie Pharmaceutical Co., Ltd.)

Chair: Silke Cameron (Germany)
and Shin Takayama (Tohoku Univ., Japan)

S3-1 Preclinical and gene expression study of new herbal preparation targeting triple-negative breast cancer

Seong-Gyu Ko (Korea)

S3-2 The potential role of *Solanum nigrum* in treating various cancers

Chen-Jei Tai (Taipei Medical Univ., Taiwan)

S3-3 Identification of distinct symptom sets predictive of positive outcome for treatment of headache with two Kampo formulae by using TOMRASS, a patient-based questionnaire database

Yoko Kimura (Tokyo Women's Medical Univ., Japan)

16:05 – 16:35 Invited Lecture 4

Chair: Yoko Kimura (Tokyo Women's Medical Univ., Japan)

IL-4 Heal the body by treating skin

Fumino Ninomiya (Aoki Clinic, Japan)

16:40 – 17:00 Farewell ceremony

Room B1

10:00 – 12:00 Japan Session (talk in Japanese)

Chair: Keisuke Hagihara (Dept. Kampo Med, Osaka Univ. Grad. Sch. Med., Japan)

萩原圭祐 (阪大院医漢方医学寄附講座)

Nakata Hideyuki (Kampo Medicine Center, Nerima Sogo Hospital, Japan)

中田英之 (練馬総合病院漢方医学センター)

JS-1 Overview of the role of the oriental medicine on the frailty and sarcopenia – the evidence of anti-sarcopenic effect of Go-sha-jinki-Gan (牛車腎気丸) / フレイルサルコペニアでの東洋医学の役割—オーバービュー—牛車腎気丸の抗サルコペニア効果について

Keisuke Hagihara (Dept. Kampo Med, Osaka Univ. Grad. Sch. Med., Japan) /

萩原圭祐 (大阪大学大学院医学系研究科漢方医学寄附講座)

JS-2 Disease Modifying therapy of Alzheimer's disease in the near future – from the aspect of psychological frailty – / アルツハイマー病治療の今後の展望について—精神心理的フレイルの側面から—

Shinji Tagami (Dept. Psychiatry, Osaka Univ. Grad. Sch. Med., Japan) /

田上真次 (大阪大学大学院医学系研究科精神医学)

JS-3 The consideration of frailty from the point of view of home pharmacist / 在宅薬剤師の立場からフレイルを考える

Hitoshi Teramoto (Aoi Pharmacy, Japan) / 寺本 仁 (あおい薬局)

JS-4 Collaborative approaches to frailty in Oriental medicine / フレイルに対する東洋医学連携アプローチ

Hideyuki Nakata (Kampo Medicine Center, Nerima Sogo Hospital, Japan) /

中田英之 (練馬総合病院漢方医学センター)

15:05 – 16:30 Lectures open to the public (talk with Japanese) / 市民公開講座 (日本語)

Chair: Hirofumi Tomori (Naha City Hospital, Japan) / 友利寛文 (那覇市立病院)

OP-1 Kampo Q&A / 漢方 Q&A

Cholsong Yang (Yan Herb Clinic, Japan) / 梁哲成 (やんハーブクリニック)

OP-2 Why do we need Kampo Medicine in modern society? /

なぜ現代においても漢方は必要とされるのか？

Yasuo Nakahara (Nakahara Kampo Clinic, Japan) / 仲原靖夫 (仲原漢方クリニック)

Room A2

14:15 – 14:45 Education Lecture 7

Chair: Zuimei Miyazaki (Miyazaki Clinic, Japan)

- EL-7 Integrating traditional Chinese medicine healthcare into diabetes care by Reducing the risk of developing breast cancer among type 2 diabetic patients: A populationn based case control study**
Jung-Nien Lai (China Medical University, Taiwan)

14:50 – 15:20 Education Lecture 8

Chair: I-Hshin Lin (Tzu Chi Univ., Taiwan)

- EL-8 Beneficial effect of *Vitis thunbergii* on osteoporosis**
Wen-Fed Chiou (Ministry of Health and Welfare, Taiwan)

15:25 – 15:55 Education Lecture 9

Chair: Klaus Hambrecht (Clinic for Chinese Medicine, Germany)

- EL-9 Current state of ISO - terms and concepts and those power**
Yasuyuki Hirose (Univ. of the Ryukyus, Japan)

16:00 – 16:30 Education Lecture 10

Chair: Kenny Kuchta (National Institute of Health Sciences, Japan)

- EL-10 Current state of the ISO - process relating to Kampo-TCM-Oriental medicine**
Hans Rausch (Germany)

Poster presentations

Medicinal History

- P-1 The dispute and the dilemma of Chinese herb management in Taiwan**
Po-Hsun Chen (Inst. Science, Technology and Society, National Yang Ming Univ., Taiwan)
- P-2 To explore the usage of porridge from the Chinese classics of traditional and modern discourse**
Mei-Tian Jou (Grad. Inst. Chinese Medicine, China Medical Univ., Taiwan)
- P-3 To explore the abdominal diagnosis from the “Zu Bing Yuan Hou Lung” (General treatises on the causes and symptoms of diseases)**
Li-Min Chueh (Grad. Inst. Chinese Medicine, China Medical Univ., Taiwan)
- P-4 A study on sudatoriums for sweating treatment in Joseon dynasty, Korea -based on the annals of the Joseon Dynasty-**
Jichung Song (Coll. Korean Medicine, Daegu Haany Univ., Kyungbuk, Korea)
- P-5 Bibliographic analysis of Ben Lou (abnormal uterine bleeding) in encyclopedia of traditional Chinese medicine**
Yi-Rong Lin (Grad. Inst. Chinese Medicine, China Medical Univ., Taiwan)
- P-6 The influence of the official medical educational policies on the development of Sphygmography during Ming and Ching dynasties**
Hui-Mei Chen (Grad. Inst. Chinese Medicine, China Medical Univ., Taiwan)
- P-7 A review of the development of Eastern and Eastern breast cancer management methods from the 14th to 19th century**
Chiu-Hui Chao (Grad. Inst. Chinese Medicine, China Medical Univ., Taiwan)
- P-8 Sohaku Asada and his student in newspaper in Meiji era**
Takanori Matsuoka (Toho, Univ. School of Medicine, Japan)
- P-9 A study of the norms of traditional Chinese medicine since late Qing dynasty (1840-1949)**
Hsuan-Ching Tseng (Grad. Inst. Chinese Medicine, China Medical Univ., Taiwan)
- P-10 Finding the Meridian & Five Elements: in a View of TCM Literature**
Chi-Fang Chen (Grad. Inst. Chinese Medicine, China Medical Univ., Taiwan)

- P-11 The Implication of NUMBER in Shanghan Lun -Take the Hetu (河圖) and Five phases for example.**
Shu-Yun Huang (Chinese Medicine Dept. Chi Mei Medical Center, Taiwan)
- P-12 Studies on processed licorice (1) - Herbological and analytical studies of roasted licorice (炙甘草) and honey-roasted licorice (蜜炙甘草)**
Misato Ota (Dept. Pharmacognosy, Grad. Sch. Pharm. Sci., Nagoya City Univ., Japan)

Experimental Pharmacology for Traditional Medicines

- P-13 Studies on processed licorice (2) - Comparison of the immunostimulatory effects among licorice (甘草) samples with or without heat-processing and pre-treatment with honey in cultured intestinal epithelial cells**
Yasutaka Nagachi (Dept. Pharmacognosy, Grad. Sch. Pharm. Sci., Nagoya City Unive., Japan)
- P-14 Ameliorating effects *Amomum cadamomum* Linné of on TNF- α -induced adipocyte dysfunction**
Kyung Hwa Kang (Dept. Physiology, Coll. Korean Medicine, Dongeui Univ., Korea)
- P-15 Significant inhibition of leukemia WEHI-3 cells growth by arsenic trioxide and extract of *Hedyotis diffusa* Willd *in vitro* and *in vivo***
Yu. Jui Kuo (Grad. Inst. Chinese Medicine, China Medical Univ., Taiwan)
- P-16 Anti- α -glucosidase and antin dipeptidyl peptidasen IV activities of extracts and purified compounds from *Vitis thunbergii* var. *taiwaniana***
Yin-Shiou Lin (Grad. Inst. Pharmacognosy, Taipei Medical Univ., Taiwan)
- P-17 Hypoglycemic effects of ethanol extracts of *Cajanus cajan* (L.) Millsp. roots in rats**
Yen Fong Lin (Dept. Bioindustry Technology, Dayeh Univ., Taiwan)
- P-18 Salvianolic acid B from Danshen (*Radix Salviae Miltiorrhizae*) via ARHGAP22 for modulating diabetic retinopathy progression**
Yu-Chuen Huang (China Medical Univ. Hospital, Taiwan)
- P-19 β -cell regeneration in STZ DM rats as an alternate antihyperglycemic mechanism of *Psidium guajava* L. extract**
Huang Shu-Ming (Dept. Food & Beverage Management, Fortune Inst. Technology, Taiwan)

- P-20 Effect of resveratrol oligomers on anti-glycation, monoamine oxidase b inhibitory activities, and protection against methylglyoxal-induced SH-SY5Y cytotoxicity**
Yi-Shan Lee (Grad. Inst. Pharmacognosy, Taipei Medical Univ., Taiwan)
- P-21 Ameliorative and synergistic effects of ergothioneine and hispidin on memory dysfunction in diabetic mice**
Tuzz-Ying Song (Dept. Bioindustry Technology, Dayeh Univ., Taiwan)
- P-22 Ginseng flower reversed the memory deficits caused by high fructose-fed rats via cortical antioxidant defenses and CREB-1 levels**
Chi-Rei Wu (Depart. Chinese Pharm. Sci. Chinese Med. Resources, China Med. Univ., Taiwan)
- P-23 Anti-depressant-like activities of probiotic and plant ferment in chronic corticosterone-treated mice**
Yen-Wenn Liu (Inst. Biochemistry and Molecular Biology, National Yang-Ming Univ., Taiwan)
- P-24 p-Hydroxybenzyl alcohol, an active phenolic ingredient of *Gastrodia elata*, reverses the cycloheximide-induced memory deficit through activating adrenal gland in rats**
Fan-Shiu Tsai (The Sch. Chinese Medicine for Post-Baccalaureate, I-Shou Univ., Taiwan)
- P-25 Antidepressant-like activity of the extract from Semen Cucurbitae after application of atmospheric plasma technology in the forced swimming test and in the tail suspension test in mice**
Yun-Chieh Chen (Sch. Pharmacy, Coll. Pharmacy, China Medical Univ., Taiwan)
- P-26 Acupuncture and electroacupuncture deliver a TRPV1-dependent signaling pathways in central spinal cord level**
Ming-Yen Chen (Grad. Inst. Acupuncture Science, China Medical Univ., Taiwan)
- P-27 Therapeutic effect of electroacupuncture on a mice fibromyalgia pain model: Role of nmda receptors and related mechanisms**
Jun Yang (China Medical Univ. Hospital, Dept. Chinese Medicine, Taiwan)
- P-28 Analgesic effect of electroacupuncture in a mouse fibromyalgia model: role of ASIC3 and relevant molecules**
Liang-Ta Yen (Grad. Inst. Acupuncture Science, China Medical Univ., Taiwan)

- P-29 Processed aconite root (附子) and its active ingredient neoline may alleviate oxaliplatin-induced peripheral neuropathic pain**
Toshiaki Suzuki (Dept. Pharmacognosy, Grad. Sch. Pharm. Sci., Nagoya City Univ., Nagoya, Japan)
- P-30 Partial activation and inhibition of TRPV1 channels by evodiamine and rutaecarpine, two major components of *evodiae fructus***
Shenglan Wang (Dept. Pharmacy, Sch. Pharmacy, Hyogo Univ. Health Sciences, Japan)
- P-31 Paeonol increases the excitability and reduces delayed outward potassium currents in hippocampal CA1 neurons: role of Kv 2.1**
Chin-Tsang Yang (Sch. Chinese Medicine, China Medical Univ., Taiwan)
- P-32 Protective effects of loganin against Parkinson's toxin-induced neurite damage and apoptotic cell death in primary mesencephalic neurons**
Yu-Ting Tseng (Grad. Inst. Natural Products, Coll. Pharmacy, Kaohsiung Med. Univ., Taiwan)
- P-33 Increasing neuroprotective effects of micronized *Hericium erinaceus* mycelium showed promising in anti-Parkinson's disease**
Yu-Min Lin (JOWIN BIOPHARMA, New Taipei City, Taiwan)
- P-34 Dual Effect of WIN-34B, a new herbal medicine, on osteogenesis and anti-osteoclastogenesis in cytokine-induced mesenchymal stem cells and bone marrow cells**
Yong-Hyeon Baek (Dept. Acupuncture & Moxibustion, Coll. Korean Medicine, Kyung Hee Univ., Korea)
- P-35 Antioxidant and osteogenetic activities of *Wikstroemia taiwanensis***
Fang-Yu Liang (Grad. Inst. Pharmacognosy, Taipei Medical Univ., Taiwan)
- P-36 Evaluation of osteogenetic and antioxidant activities as well as the chemical analysis of Taiwanese endemic plants**
Tzu-Tung Liao (Grad. Inst. Pharmacognosy, Taipei Medical Univ., Taiwan)
- P-37 The active flavonoids isolated from the leaves of *Eriobotrya deflexa***
Yi-Tzu Lin (Ph.D. Program for the Clinical Drug Discovery from Botanical Herbs, Taipei Med. Univ., Taiwan)
- P-38 *Phellinus igniarius* extract inhibits hepatitis B virus infection in human hepatocytes**
Cheng Huang (National Research Inst. Chinese Medicine, Taiwan)

- P-39 The hepatoprotective effect of *scoparia dulcis* on carbon tetrachloride induced chronic liver injury in mice**
 Bao-jiyi Chen (Coll. Biotechnology and Bio-resources, Da-Yeh Univ., Taiwan)
- P-40 Hepatoprotective effect of *Polygonum orientale* on carbon tetrachloride-induced acute liver damage in mice**
 Hao Yuan Cheng (Chung-Jen Junior Coll. Nursing, Health Sciences Management, Taiwan)
- P-41 Scutellariae radix and Rhei rhizoma formula alleviates chemical-induced liver fibrosis in a rat model**
 Tai-Long Pan (Sch. Traditional Chinese Medicine, Chang Gung Univ., Taiwan)
- P-42 Antroquinonol ameliorates alcoholic liver disease induced by chronic plus binge ethanol feeding in mice**
 Hsin-Yi Yang (Dept. Nutrition, I-Shou Univ., Taiwan)
- P-43 *Buddleja officinalis* MAXIM. flower extract prevents oxidative stress-mediated hepatic injury via AMPK activation**
 Ji Yun Jung (Coll. Korean Medicine, Daegu Haany Univ., Korea)
- P-44 Isoliquiritigenin inhibits hepatic oxidative damage via ERK/Nrf2 pathway**
 Sang Mi Park (Coll. Korean Medicine, Daegu Haany Univ., Korea)
- P-45 Effect of Goreisan (五苓散) on urinary concentrating ability and expression of aquaporins in Uninephrectomized rats**
 Michiko Jo (Dept. of Kampo Diagnostics, Inst. Natural Medicine, Univ. Toyama, Japan)
- P-46 Inhibited effect of keishibukuryogan (桂枝茯苓丸) added with Rhubarb (Rhei Rhizoma, Daio) on progression of renal dysfunction in 5/6 nephrectomized rat**
 Naotoshi Shibahara (Dept. Kampo Diagnostics, Inst. Natural Medicine, Univ. Toyama, Japan)
- P-47 Protective effects of bromelain on doxorubicin-induced short- and long-term cardiac and renal dysfunction in rat model**
 Yueh-Chiao Yeh (Dept. Natural Biotechnology, Nanhua Univ., Taiwan)
- P-48 p-Hydroxyacetophenone inhibits the expression of NF- κ B in λ -carrageenan induced inflammation in mice**
 Chang Ching-Wen (Dept. Chinese Pharm. Sci. Chinese Med. Resources, Coll. Biopharm. Food Sci., China Med. Univ., Taiwan)

- P-49** **Development of a rapid identification compounds from *Angelica keiskei* Koidzumi (Ashitaba) with tyrosinase inhibitory activities by UPLC-MS/MS**
Jia-Hao Lee (Sch. Pharmacy, Taipei Medical Univ., Taiwan)
- P-50** **Anti-inflammatory effects of the fermentation extracts consisting of soybean, red ginseng and Citrus Unshiu Peel**
Sook Jahr Park (Medical Research Center Globalization Herbal Formulation, Coll. Korean Medicine, Daegu Haany Univ., Korea)
- P-51** **Effects of Shin'iseihaito (辛夷清肺湯) on allergic sinusitis induced by ovalbumin in mice**
Toru Konishi (Dept. Pharmacognosy, Grad. Sch. Pharm. Sci., Nagoya City Univ., Nagoya, Japan)
- P-52** **Zerumbone enhances the Th1 response and ameliorates ovalbumin-induced Th2 responses and airway inflammation in mice**
Ying-Hua Shieh (Dept. of Family Medicine, Wan Fang Hospital, Taipei Medical Univ., Taiwan)
- P-53** **Eriodictyol ameliorates lipopolysaccharide-induced acute lung injury in mice through reducing inflammation**
Wang-Rong Lin (Dept. Chin. Pharm. Sci. Chin. Med. Resources Inst., Taiwan)
- P-54** **Ban Long Wan inhibits the LPS-induced inflammation in RAW264.7 cells and mouse models**
Jui-Shu Chang (Sch. Chin. Med., Grad. Inst. Integr. Med. Coll. Chin. Med., China Med. Univ., Taiwan)
- P-55** **Anti-inflammatory steroid from *Phragmites* rhizoma modulates LPS-mediated signaling through inhibition of NF- κ B pathway**
Jong Rok Lee (Dept. Pharmaceutical Engineering, Daegu Haany Univ., Korea)
- P-56** **Anti-hyaluronidase activity and immune response by tomato saponin, esculeoside A / esculeoside B**
Jian-Rong Zhou (Faculty Pharm. Sci., Sojo Univ., Japan)
- P-57** **Pharmacological effects of Pruni cortex (*Prunus jamasakura* Siebold ex Koidzumi) on inflammation induced by *Propionibacterium acnes***
Chiaki Murayama (Kampo Research Laboratories, Kracie Pharma Ltd., Japan)
- P-58** **Anti-osteoarthritis effects of 2, 3, 5, 4'-tetrahydroxystilbene-2-O- β -D-glucoside from *Polygoni multiflori* in vitro and in vivo**
Po-Wei Tsai (Dept. Fashion Design Styling, Fortune Inst. Technology, Taiwan)

- P-59 San'oshashito (TJ-113, 三黃瀉心湯) improves postmenopausal ischemia reperfusion injury via its estrogenic effects**
Mayuko Sakanashi (Dept. of Pharmacol., Grad. Sch. Medicine, Univ. the Ryukyus, Japan)
- P-60 Regulation of *Helminthostachys zeylanica* (L.) Hook extracts in intestinal cytokine and anti-inflammatory effects during acute colitis**
Li-Ching Chang (Dept. Occupational Therapy, I-Shou Univ., Taiwan)
- P-61 Studies of *Punica granatum* on the radiation-induced biological damages *in vitro* and *in vivo* tests**
Chia-Jung Lee (Ph.D. Program for Clinical Drug Discovery Chin. Herbal Med., Coll. Pharm., Taipei Med. Univ., Taiwan)
- P-62 A comparative preclinical pharmacokinetics of herbal ingredient following oral administration of single compound, single herb and multiple herbal formulation in rats**
Tung-Hu Tsai (Inst. Traditional Medicine, Sch. Medicine, National Yang-Ming Univ., Taiwan)
- P-63 Effect of Yin Qiao San (銀翹散) against *Streptococcus pneumoniae* murine model by microarray analysis**
Masaaki Minami (Dept. Bacteriology, Grad. Sch. Medical Sciences, Nagoya City Univ., Japan)
- P-64 Cancelled**
- P-65 Adjunctive traditional Chinese medicine therapy improves survival of patients with pancreatic cancer in Taiwan: A nationwide population-based study**
Yi-Ting Kuo (Sch. Chinese Medicine, China Medical Univ., Taichung, Taiwan)
- P-66 Anti-metastasis effects of Gilgyung-tang on human bladder cancer cell are related with suppressing MMP-2 and -9 expressions - an *in vitro* study**
Su Hyun Hong (Dept. Biochemistry, Dongeui Univ. Coll. Oriental Medicine, Korea)
- P-67 Norcantharidin-induced apoptosis stress signaling: modulation of the Akt/FoxO4/Mcl-1 signaling cascade in prostate cancer cells**
Yi-Hsien Hsieh (Dept. Biochemistry, School of Medicine, Chung Shan Medical Univ., Taiwan)

- P-68 Apoptotic cell death by Hwangheuksan (黃黑散), a traditional herbal formulation, in HCT116 human colorectal cancer cells: Roles of ROS generation and PI3K/Akt signaling pathway**
Yung Hyun Choi (Dept. Biochemistry, Dongeui Univ. Coll. Korean Medicine, Korea)
- P-69 Targeting colon cancer stem cell by anthraquinone: Insight into mechanism and therapeutic target**
Cheng-Wei Lin (Dept. Biochem. and Mol. Cell Biol., Coll. Medicine, Taipei Medical Univ., Taiwan)
- P-70 Knockdown of Pentraxin 3 suppresses tumorigenicity and metastasis of human cervical cancer cells**
Yi-Hsien Hsieh (Dept. Biochemistry, Sch. Medicine, Chung Shan Medical Univ., Taiwan)
- P-71 The cytotoxic effect and molecular mechanism of nonylphenol in human gastric cancer cells**
Chun-Chi Kuo (Dept. Nursing, Tzu Hui Inst. Technology, Taiwan)
- P-72 Synergistic apoptotic effect of fisetin in combination with sorafenib in human cervical cancer HeLa cells through activation death receptor-5 mediated caspase-8/-3 and mitochondria-dependent apoptotic pathway**
Chia-Liang Lin (Inst. Biochem., Microbiol. Immunol., Chung Shan Medical Univ., Taiwan)
- P-73 Short-hairpin RNA-mediated ESM-1 silencing promote human prostate cancer cell proliferation, migration and invasion**
Chu-Liang Lin (Inst. Biochem. Biotech., Coll. of Medicine, Chung Shan Medical Univ., Taiwan)
- P-74 The anti-metastasis effect of omega-3 fatty acids derivatives in prostate cancers.**
Chi-Ming Liu (Dept. Nursing, Tzu Hui Inst. Technology, Taiwan)
- P-75 Quercetin induced apoptosis of human oral cancer SAS cells through mitochondria and endoplasmic reticulum mediated signaling pathways**
Yi-Shih Ma (Dept. Chinese Medicine, E-Da Hospital, Kaohsiung, Taiwan)
- P-76 Inhibition of pentraxin 3 in glioma cells impairs proliferation and invasion *in vitro* and *in vivo***
Te-Fang Yang (Inst. Biochemistry, Microbiol. Immunol., Chung Shan Medical Univ., Taiwan)

- P-77** ***Morinda citrifolia* fruit water-EtOAc extracts induced apoptosis in human breast and liver cancer cells**
Hsiu chen Huang (Dept. Applied Science, National Hsinchu Univ. Education, Taiwan)
- P-78** **Naringenin inhibited migration of lung cancer cells via inhibition of MMP-2 and MMP-9**
Yuh-Ming Chang (Inst. Biochem. Biotechnol., Chung Shan Medical Univ., Taiwan)
- P-79** **Synthesis and 3D-QSAR model of Jolkinolide analogues**
Ke Wang (Sch. Pharm., Coll. Pharm., China Medical Univ., Taichung, Taiwan)
- P-80** **A novel synthetic 7-arylindoline-1-benzenesulfonamides with anticancer activity in Colorectal cancer HCT116 cells**
Tung Yun Wu (Ph.D. Program Clin. Drug Discovery Botanical Herbs, Taipei Med. Univ., Taiwan)
- P-81** **Potential anti-cancer therapy in non-small cell lung cancer with traditional Chinese Medicine *Corex mori* and cisplatin**
Ming-Wei Chao (Dept. Bioscience Technology, Chung Yuan Christian Univ., Taiwan)
- P-82** **Beneficial effects of Xue-Fu-Zhu-Yu decoction (血府逐瘀湯) on metabolic stressed APPswe/PS1dE9 mice.**
Hui-Kang Liu (Div. Basic Chinese Medicine, National Research Inst. Chinese Medicine, Ministry of Health and Welfare, Taiwan)
- P-83** **Search of the active effective crude drugs in goshajinkigan (牛車腎氣丸) on muscle atrophy of the senescence-accelerated mice**
Tomoaki Ishida (Dept. Pharmacognosy, Grad. Sch. Pharm. Sci., Nagoya City Univ., Nagoya, Japan)
- P-84** ***In vitro* preventive effect of the extract of goshajinkigan (牛車腎氣丸) on muscle atrophy and its active constituents**
Ke Ye (Dept. Pharmacognosy, Grad. Sch. Pharm. Sci., Nagoya City Univ., Nagoya, Japan)
- P-85** **The putative mechanism of *Cynomorium songaricum* on preventing aging**
Wei-Yong Lin (Grad. Inst. Integrated Medicine, China Medical Univ., Taiwan)
- P-86** **Functional components analyses and assessments of water and ethanol extracts from *Djulis* sprouts**
Jing-Bin Huang (Dept. Bioindustry Technology, Dayeh Univ., Taiwan)

- P-87 Screening of crude drugs used in Japanese traditional Kampo medicine that have inhibitory effect of organic anion transporting peptide (OATP)-2B1**
Rie Iijima (Dept. Pharmacognosy, Grad. Sch. Pharm. Sci., Nagoya City Univ., Nagoya, Japan)
- P-88 Study the effect of *Angelica sinensis* (Oliv) on cytochrome P450 in HepG2 cell line**
Shih. Yin Chen (Sch. Chinese Medicine, China Medical Univ., Taiwan)
- P-89 A Study on food cure for stomach diseases - Focusing on Eumsunjungyo-Singnyojabyeong**
Jin Im Hong (Dept. Medicine Classics, Coll. of Korean Medicine, Deajeon Univ., Korea)
- P-90 A study on analyzing the relationship of formulae with comparing its components (2)**
Heewon Jang (Dept. Medical Classics, Coll. Korean Medicine, Wonkwang Univ., Korea)
- P-91 Comparison of Chrysanthemi Flos (菊花) derived from *Chrysanthemum morifolium* and *C. indicum* about the agonistic activity on PPAR γ and their active ingredients**
FuZi Zhang (Dept. Pharmacognosy, Grad. Sch. Pharm. Sci., Nagoya City Univ., Nagoya, Japan)
- P-92 The development of IPCD method n Quick and easy preparation method for decoctions of Kampo formula inspired by the method of boiling powdered crude drugs in the Song period of China n**
Tsukasa Fueki (Matsuya Pharmacy, Japan)

Quality control for traditional medicines

- P-93 Optimization of resveratrol derivatives production from peanut (*Arachis hypogaea* L.)**
Lih-Geeng Chen (Dept. Microbiology, Immunol. Biopharmaceuticals, National Chiayi Univ., Taiwan)
- P-94 Comparative study on herbal extract formulations covered by the national health insurance in Korea, Japan, and Taiwan**
Ching-Wen Huang (Inst. Safety, Efficacy Effectiveness Evaluation Korean Med., Kyung Hee Univ., Korea)

- P-95 Quantitative determination of ergosterol and ergosterol peroxide in silkworm *Cordycep militaris* by thin layer chromatography**
Lie-Chwen Lin (National Research Inst. Chinese Medicine, Minist. Health Welfare, Taiwan)
- P-96 The study of enhancement method for efficiency and objectivity discrimination of medical herb**
Young-Sung Ju (Coll. Korean Medicine, Woosuk Univ., Korea)
- P-97 the turnover rate of baicalin, in *Scutellaria baicalensis* and glycyrrizin, in *Glycyrrhiza uralensis* between 50% ethanol and hot water extract**
Chia-Jung Lee (Ph.D Program Clin. Drug Discovery Botanical Herbs, Taipei Med. Univ., Taiwan)
- P-98 Antioxidant constituents of mulberry leaves**
Jerome G. Ganzon (Sch. Pharm., Coll. Pharm., Taipei Medical Univ., Taiwan)
- P-99 The quality of Chenpi (陳皮) depends on the processing of air dried time**
Ya-Chieh Tsai (Grad. Inst. Pharmacognosy, Taipei Medical Univ., Taiwan)
- P-100 the turnover rates of substance markers from *Paeonia lactiflora* in traditional Chinese medicine decoctions**
Li-Yao Tsai (Sch. Pharm., Coll. Pharm., Taipei Medical Univ., Taiwan)
- P-101 establishment of the botanical reference materials for traditional Chinese medicine**
Kun-Teng Wang (Brion Research Inst. Taiwan, Taiwan)
- P-102 effects of post-harvest drying method on the biological activity of *Uraria crinita***
Jung Chao (Dept. Inst. Pharmacology, National Yang-Ming Univ., Taiwan)

Clinical studies for acupuncture and moxibustion

- P-103 Oral decoctions and acupuncture as seen from a physiological viewpoint and the point of change in treatment method**
Hiroshi Kanda (Japan Inst. Natural Medicine, Japan)
- P-104 Discussion five shu points collocates with four seasons**
Cheng Wan-Chun (Grad. Inst. Chinese Med., Coll. Chinese Med., China Medical Univ., Taiwan)

- P-105 Effect of JianJing (GB21) cupping therapy on flow acceleration of middle cerebral artery : Case report**
Hobin Moon (Bichedam Clin. Korean Medicine, Korea)
- P-106 Adverse event reports in Ehime prefectural central hospital east Asian traditional medicine acupuncture and moxibustion care unit**
Yuse Okawa (Dept. East Asian Traditional Medicine, Ehime Prefectural Central Hospital, Japan)
- P-107 Risk associated with bee venom therapy: A systematic review and meta-analysis**
Jeong Hwan Park (Korea Inst. Oriental Medicine, Korea)
- P-108 Influences of stimulation with moxibustion on gastric motility and heart rate variability**
Junji Miyazaki (Dept. Acupuncture, Takarazuka Univ. Medical Health Care, Japan)
- P-109 Laser acupuncture in simple obesity therapy: Preliminary results of a trial on an alternative treatment for reducing weight**
Chen-Cheng Yang (Health Management Center, Kaohsiung Municipal Ta-Tung Hospital, Taiwan)
- P-110 Acupuncture and Leeches is the complex treatment of a facial nerve's neuropathy**
Yury Ponomarev (Clin. Oriental Medicine, Vladivostok, Russia)
- P-111 Moxibustion improved knee pain of cancer-bearing woman by stimulating TRP (Transient Receptor Potential) channels: a case report**
Yukari Nose (Mie Univ., Hospital Dept. Integrated Medicine/Acupuncture Moxibustion, Japan)
- P-112 Efficacy of placenta therapy on different types of diseases -Acupuncture point injection-**
Mahiko Nagase (Kichijyoji Traditional Chinese Medicine Clinic, Japan)
- P-113 Acupuncture point injection; A new method for improving complex regional pain syndrome**
Kyeong Mee Park (Inno Oriental Clinic, Korea)
- P-114 Acupuncture improves the QOL of patients with cancer under palliative care**
Ai Kouchi (Dept. Oriental Integr. Med., Saitama Medical Univ.)

- P-115 Quality of randomized control trials on acupuncture conducted in Japan - Evaluation using Cochrane risk of bias tool -**
Shoko Masuyama (Morinomiya Univ. of Medical Sciences, Japan)
- P-116 Three cases of cutaneous warts treated with moxibustion**
Youngee Yun (Dept. Dermatol. Korean Med., Coll. Korean Med., Kyung Hee Univ., Korea)
- P-117 The relaxing effect of lower leg acupuncture stimulation on univ. students who live a sedentary lifestyle, from the perspectives of physical movement and autonomic nerve activity -Considerations based on a randomized controlled trial-**
Hiroie Motoyama (Grad. Sch. Life Sci. Systems Engineering, Kyushu Inst. Technology, Japan)
- P-118 Magnetic resonance imaging for optimal needling depth in different hegu acupuncture points**
Yiu Ming Wong (Hong Kong Physically Handicapped & Able Bodied Association, Hong Kong)
- P-119 A survey of adverse events by acupuncture using accident information databank**
Hisashi Shinbara (Meiji Univ. Integrative Medicine, Japan)
- P-120 Patient safety on periocular acupuncture therapy**
Ying-Ling Chen (TCM Integrated Information Center, Dept. Chinese Med., Changhua Christian Hospital, Taiwan)
- P-121 Korean medical obesity treatments on localized fat in three Japanese**
Yong-ho Lee (Onbody Korean Medicine Clinic, Korea)
- P-122 Three periods of greatest heat days treats the allergic disease**
Yu-Chen Lee (Dept. Acupuncture, China Medical Univ. Hospital, Taiwan)
- P-123 The clinical effectiveness of auricular acupressure using the National Acupuncture Detoxification Association (NADA) protocol for methamphetamine dependent humans: A clinical pilot study**
Bernice Lottering (Intl. Master Program, Grad. Inst. Acupuncture Sci., China Medical Univ., Taiwan)
- P-124 Safe needling depths of upper back acupoints in children**
Yi-Chun Ma (SGrad. Inst. Chinese Medicine, China Medical Univ., Taiwan)

- P-125 20 cases of warts treated by Saengki SBT (Self Balancing Therapy)**
Chiyoung Park (Saengki Oriental Medical Clinic, Korea)
- P-126 Effect of acupuncture on cerebral blood flow in patients with migraine measured by arterial spin labeling MRI method**
Tomokazu Kikuchi (Dept. Oriental Integr. Med., Saitama Medical Univ.)
- P-127 The effect of point stimulations with tuning forks**
Yoshiko Naito (Naito Acupuncture Moxibustion Clinic, Japan)
- P-128 The selection of the acupuncture points for febrile disease**
Hidetoshi Yamaguchi (Yanagihara Acupuncture Moxibustion Clinic, Japan)
- P-129 The effects of season and plant height on the constitution of the fruits according to the Circle theory**
Shih-chin Wei (TCM Integrated Information Center, Dept. Chinese Medicine, Taiwan Christian Hospital)

Clinical studies for traditional medicines

- P-130 To assess drug side effects in traditional chinese medicine theory**
Jian-Ruei Ciou (School of Chinese Medicine, Coll. of Chinese Medicine, China Medical Univ., Taiwan)
- P-131 Investigation of characteristics of traditional Chinese medicine constitutions in patients with angina**
Yi-Chia Huang (Grad. Inst. Chinese Med., Coll. Chinese Med., China Med. Univ., Taiwan)
- P-132 Treatment using herbal patches on acupoints in alleviating paralytic ileus**
Lih-Lian Chen (Dept. Traditional Chinese Medicine, En Chu Kong Hospital, Taiwan)
- P-133 Ogikenchu-to (黄耆建中湯) improves upper and lower back pain**
Fumiko Nishimori (Nishimori Naonote Clinic, Japan)
- P-134 An online survey of adverse events of electroacupuncture in Korean**
EunKyung Bae (Korea Inst. Oriental Medicine, Korea)

- P-135 Clinical research trend for integrative medicine in Korea; A systematic review**
Eui-Hyoung Hwang (Dept. Rehabilitation Med. Korean Med., Pusan National Univ. Korean Med. Hospital, Korea)
- P-136** Cancelled
- P-137 Treatment of acute flare of atopic eczema after long term remission using Chinese herbal medicine.**
Akiyoshi Yamanaka (Yurigaoka Clinic, Japan)
- P-138 Upper gastrointestinal bleeding with blood and energy deficiency of small intestine and stomach meridians by electrodermal screening**
Yu. Chiang Hung (Dept. Chinese Med., Kaohsiung Chang Gung Memorial Hospital, Taiwan)
- P-139 Identification of tongue and pulse indices which related to abnormal constitution**
Shan-Yu Su (Dept. Chinese Medicine, China Medical Univ. Hospital, Taiwan)
- P-140 A pilot study on developing the pulse diagnosis instrument from a research of preload pressure setting**
Yun. Ning Tsai (Grad. Inst. Chinese Med., College of Chinese Med., China Med. Univ., Taiwan)
- P-141 SEED: the six excesses (Liu Yin) evaluation and diagnosis scale** PeiJung Chiang (Taichung Veterans General Hospital, Taiwan)
- P-142 The constitution and heart rate variability in lupus nephritis**
Hen. Hong Chang (Sch. Chinese Med., Research Center for Chinese Med. Acupuncture, China Medical Univ., Taiwan)
- P-143 The relationship between tongue color and the subjective premenstrual body weight change**
Yin. Jen Chang (Dept. Chinese Medicine, China Medical Univ. Hospital, Taiwan)
- P-144 The investigation to standard abdominal patterns of Tokin Shakuyakun San (当归芍药散) or Keishin bukuryon Gan (桂枝茯苓丸) in Kampo medicine** Shuji Yakubo (Div. General Medicine, Dept. Medicine, Nihon Univ., Sch. Med., Japan)

- P-145 A Comparison of two Chinese medical constitution questionnaires: A pilot study**
Yu-Chun Lin (Sch. Chinese Medicine, China Medical Univ., Taiwan)
- P-146 Hangekobokuto (半夏厚朴湯) mainly improved chilliness and constipation of patients who had fulfilled the criteria of a questionnaire for the diagnosis of Qi stagnation (氣滯)**
Mitsuyuki Takamura (Mie Univ. Hospital Kampo Medicine Outpatient Department, Japan)
- P-147 Comparison of the sublingual vein in a seated and supine position**
Akira Morita (Dept. Japanese-Oriental (Kampo) Med., Grad. Sch. Med., Chiba Univ., Japan)
- P-148 Preliminary study of a diagnostic tool for cold sensation of hands**
Yui Sasaki (Dept. of Preventive Medicine, Coll. Korean Medicine, Kyung Hee Univ., Korea)
- P-149 "Side effect" of medicinal cooking based on Kampo medicine**
Koichiro Tanaka (Dept. Traditional Medicine, School of Medicine, Toho Univ., Japan)
- P-150 Effectiveness of acupressure on sleep quality in surgical intensive care unit**
Li-Yu Hsiao (Kaohsiung Chang Gung Memorial Hospital, Taiwan)
- P-151 The effects of acupressure to improve gastrointestinal motility in post-surgical patients**
Chih-Ying Kuo (Kaohsiung Chang Gung Memorial Hospital, Taiwan)
- P-152 The effects of fetal respiration technique combined with aromatherapy for anxiety of spinal surgical patients**
Kuei-Feng Shih (Kaohsiung Municipal Ta-Tung Hospital, Taiwan)
- P-153 Prescribing patterns of concentrated extract product : Ge Gen Tang (葛根湯) for common cold in Taiwan: A population-based study**
Pei-Ying Chou (Grad. Inst. Pharmacognosy, Taipei Medical Univ., Taiwan)
- P-154 Prescription patterns of concentrated extract product: Ban-Xia-Xie-Xin-Tang (半夏瀉心湯) for disorders of function of stomach in Taiwan: A population-based study**
Pin-Chen Huang (Grad. Inst. Pharmacognosy, Taipei Medical Univ., Taiwan)

- P-155 Utilization of and attitudes towards traditional Chinese Medicine: A survey of customers and merchants**
Sung Hui Tseng (Dept. Physical Medicine Rehabilitation, Taipei Medical Univ. Hospital, Taiwan)
- P-156 Examination of frequency of side effects from over-the-counter Kampo formulations and ethical Kampo formulations in Japan**
Takashi Ito (Inst. Oriental Medicine, Tokyo Women's Medical Univ., Japan)
- P-157 Prescription pattern and effect on kidney of concurrent usage of metformin and Astragalus Radix on patients with type 2 diabetes in Taiwan**
Chien-tung Wu (Inst. Traditional Med., School of Med., Natl. Yang-ming Univ., Taiwan)
- P-158 A nationwide study for herbal drug safety in Korea**
Chang-Gue Son (Hepatol., Dept. Oriental Hospitals Univ. South Korea, Korea)
- P-159 Retrospective study about the effectiveness of Korean medicine treatment on 254 patients visited obesity clinic**
Yong-ho Lee (Onbody Korean Medicine Clinic, Korea)
- P-160 Adjunctive traditional Chinese medicine use reduces medical expenditure in patients with fractures in Taiwan: a nationwide population-based study**
Hou-Hsun Liao (Sch. Chinese Medicine, China Medical Univ., Taiwan)
- P-161 Prescribing patterns of concentrated extract product : Wu lin san (五淋散) for cystitis in Taiwan: A population-based study**
Steven Kuan-Hua Huan (Div. Urol. Oncol., Dept. Surgery, Chi Mei Medical Center, Taiwan)
- P-162 Ear-acupressure for primary dysmenorrhea: A systematic review**
Ching-Yi Wu (Dept. Nursing, Fooyin Univ., Taiwan)
- P-163 Quality assessment for acupuncture prevalence study at hospitals and clinics in Japan, a systematic review**
Takashi Seki (Tohoku Univ., Japan)
- P-164 The effects of acupressure massage of pulmonary diseases : A systematic review**
Hsiang-Yun Huang (Intensive Care Unit, Chi-Mei Medical Center, Taiwan)

- P-165 Research trend analysis on the cold hands and feet syndrome in the field of traditional medicine**
 Youme Ko (Inst. Safety, Efficacy Effectiveness Evaluation Korean Med., Dept. of Preventive Med., Coll. Korean Med., Kyung Hee Univ., Korea)
- P-166 A retrospective study comparing the recurrence of chronic subdural hematoma after treatment by burr hole surgery with and without postoperative administration of goreisan (五苓散)**
 Kouichiro Okamoto (Neurosurgery, National Center for Global Health Medicine, Japan)
- P-167 The effectiveness of the quality of sleep in Qigong exercise: A systematic Review**
 Yu-Chi Lin (Dept. Nursing, Yuh-ing Junior College Health Care & Management, Taiwan)
- P-168 Development a visual algorithm to realize quantitative pulse condition: normal pulse and tight pulse**
 Chun-Jen Su (Dept. Electrical Engineering, National Cheng Kung Univ., Taiwan)
- P-169 Orally effective adjuvants from Kampo medicines enhanced mucosal immune responses for nasal influenza vaccine**
 Kazumi Yokomizo (Faculty of Pharmaceutical Sciences, Sojo Univ., Japan)
- P-170 The effects of meditation for fatigue of heart failure patients**
 Lin-Tzn Chen (Dept. Nursing, Fooyin Univ., Kaohsiung, Taiwan)
- P-171 Reduced dementia in non-hemorrhagic stroke patients received acupuncture treatment: A nationwide matched-cohort study**
 Chun-Chuan Shih (Sch. Chinese Medicine Post-Baccalaureate, I-Shou Univ., Taiwan)
- P-172 A systematic review of cinnamon in patients with diabetes**
 Mei-Su Chiang (Kaohsiung Chang Gung Memorial Hospital, Taiwan)
- P-173 Analysis among tongue and heart rate variability in obese adults and it's relationship with metabolic syndrome**
 Tsung-chieh Lee (Dept. Chinese medicine, Changhua Christian Hospital, Taiwan)
- P-174 Effectiveness of Yokukansankachimpihange (抑肝散陳皮半夏) for the Treatment of behavioral and psychological symptoms of dementia**
 Atsushi Yamamoto (Dept. Dermatol., National Hospital Organization Kobe Medical Center, Japan)

- P-175 10-minute-triage for acute headache with Goreisan (五苓散) and Goshuyutou (吳茱萸湯)**
Tadashi Matsuda (Misato Family Clinic, Japan)
- P-176 Effect of electroacupuncture at bilateral ST36 acupoints on acid saline-induced fibromyalgia pain**
Kun-Ta Lee (Grad. Inst. Acupuncture Science, China Medical Univ., Taiwan)
- P-177 Study on Body Constitution Questionnaire and Traditional Chinese Medicine Clinic for Yang-Xu Syndrome Based on Blood Clinical Variables in Sub-healthy Volunteers**
Hong-Jhang Chen (National Research Inst. Chinese Medicine, Taiwan)
- P-178 Prospective double-blind randomized study on the efficacy and safety of *Antrodia cinnamomea* combined with chemotherapy in the treatment of advanced cancer**
Ming-Yen Tsai (Kaohsiung Chang Gung Memorial Hospital, Taiwan)
- P-179 Change decoction to the paste form and cover on the umbilicus to treat a patient with rectal adenocarcinoma : A case report**
Hsiang-Wen Cheng (Chinese Medical Department, Chimei Medical Center, Taiwan)
- P-180 Yang-deficiency body constitution: A significant predictive factor for moderate to severe cancer-related fatigue**
Ming-Hsien Yeh (Grad. Inst. Chinese Medicine, China Medical Univ., Taiwan)
- P-181 Kampo therapy for peripheral neuropathy complicated with anti-cancer chemotherapy**
Akimune Hayashi (Dept. Oriental Medicine, Kampo Support Center, Kanagawa Cancer Center, Japan)
- P-182 Effectiveness of Tsuhdousan (通導散) for severe lymphedema of advanced cancer patients in palliative care**
Junichi Koeda (Aomori Jikeikai Hospital, Japan)
- P-183 Efficacy and safety of Jaungo, traditional medicinal ointment, on radiation dermatitis in patients with breast cancer: a prospective, randomized controlled, single blinded, pilot study**
Jee Young Lee (Dept. Korean Internal Medicine, Korean Medicine Cancer Center, Kyung Hee Univ. Hospital Gangdong, Korea)

- P-184 Efficacy of Kampo medicine in side effects due to hormone therapy in breast cancer patients.**
Hideki Okamoto (Japanese-Oriental (Kampo) Medicine, Chiba Univ. Grad. School of Medicine, Japan)
- P-185 *In vivo* imaging of intestinal bacterial β -glucuronidase activity via enzymatic hydrolysis of a fluorescent probe**
Ting-Yu Chen (Ph.D. Program Clinical Drug Discovery Botanical Herbs, Grad. Inst. Pharmacognosy, Coll. Pharm., Taipei Medical Univ., Taiwan)
- P-186 Develop a five element pattern of healthcare model for acute lymphatic leukemia**
Mei Hua Wang (Sch. Nursing, National Taipei Univ. Nursing Health Sciences, Taiwan)
- P-187 Utilization patterns of Chinese Medicine for cancer patients in Taiwan from 2007 to 2011 a population-based study**
Hsuan-Shu Shen (Dept. Public Health, Coll. Medicine, Tzu Chi Univ., Hualien, Taiwan)
- P-188 A case of complications from bacillus calmette-- urin immunotherapy in bladder cancer patient treated with Korean medicine**
Ji-Hye Lee (Dept. Korean Internal Medicine, Pusan National Univ. Korean Medicine Hospital, Korea)
- P-189 The effects of acupressure for lower-extremity lymphedema in cancer patients**
Su. Chin Lin (Dept. Nursing, E. DA Hospital, Fooyin Univ., Taiwan)
- P-190 A randomizedn controlled study of chan-chuang qigong for patients with non-Godgkin's lymphoma undergoing chemotherapy**
Mei-Ling Yeh (School of Nursing, National Taipei Univ. Nursing Health Sciences, Taiwan)
- P-191 The combine treatment of traditional Chinese medicine and Western medicine for dengue? An experience in Taiwan**
Yu-Pei Chen (Dept. Chinese Medicine, Tainan Hospital, Ministry Health Welfare, Taiwan)
- P-192 Re-finding of Shanghan-lun (傷寒論): A retrospective cross-sectional study**
Tetsuhiro Yoshino (Center Kampo Medicine, Keio Univ. Sch. Medicine, Japan)

- P-193 Safety of daiobotanpito (大黃牡丹皮湯) in the treatment of acute diverticulitis of colon: a prospective phase II trial**
Hiroshi Koike (Center Kampo Medicine, Keio Univ. Sch. Medicine, Japan)
- P-194 The observation of humoral responses after influenza vaccination in patients with rheumatoid arthritis treated with Japanese oriental (Kampo) medicine: an observational study**
Toshiaki Kogure (Dept. Japanese Oriental Medicine, Gunma Central & General Hospital, Japan)
- P-195 Treatments of lung diseases by treating liver, kidney and spleen with Kampo medicines or traditional Chinese medicines**
Yasuyo Hijikata (Toyodo Hijikata Clinic, Japan)
- P-196 Three cases of palpitation with supraventricular or ventricular premature contraction treated successfully with Hangekobokuto (半夏瀉心湯)**
Taketoshi Yamazaki (Cardiology Center, Rakuwakai Otowa Hospital, Japan)
- P-197 An investigation of the use of acupuncture treatment in stroke patients in taiwan**
Shu-Wen Weng (Grad. Inst. Chinese Medicine, China Medical Univ., Taiwan)
- P-198 A case of treatment by ninjinto for ptialism in cerebral hemorrhagic patient**
Kazhuero Muroga (Kurokouchi Hospital, Japan)
- P-199 A case of functional dyspepsia presenting with epigastralgia that was successfully treated with Oren-gedoku-to**
Hideyuki Isobe (Dept. Orient. Integr. Med., Saitama Med. Univ.)
- P-200 The use of traditional Chinese medicines associated with reduced risk of liver cirrhosis in patients with chronic hepatitis C**
Jui-Ying Chu (Branch Linsen Chinese Medicine, Taipei City Hospital, Taiwan)
- P-201 Case report: Successful treatment of antibiotic-associated diarrhea with a herbal medicine, daiobotampito (大黃牡丹皮湯)**
Yutaka Nagata (Dept. Oriental Traditional Medical Center, Suwa Central Hospital, Japan)
- P-202 An intensive case of post-operative ileus treated with integrated medicine**
Hsiao-ling Tsou (Dept. Chinese Medicine, Chi Mei Medical Center)

- P-203 The advantages of laser acupuncture in obesity therapy**
Wen-Long Hu (Dept. Chinese Medicine, Kaohsiung Chang Gung Memorial Hospital Chang Gung Univ. Coll. Medicine, Taiwan.)
- P-204 Assessment of pre-diabetes, type 2 diabetes, and micro-vascular complications using nailfold videocapillaroscopy**
Po-Chi Hsu (Grad. Inst. Chinese Medicine, China Medical Univ., Taiwan)
- P-205 Characteristics of traditional Chinese medicine usage in children with sexual precocity: a nationwide population-based study**
Yi-Chun Lin (Dept. Chinese Medicine, China Medical Univ. Hospital, Taiwan)
- P-206 Qi-deficiency in the patients with allergic disorders**
Woo Sang Jung (Dept. Cardiology & Neurology, Coll. Korean Medicine, Kyung Hee Univ., Korea)
- P-207 Characteristics of traditional Chinese medicine users among atopic dermatitis children: a nationwide study**
Yi-Hsuan Lin (Div. Chinese Internal Medicine, Center for Traditional Chinese Medicine, Chang Gung Memorial Hospital, Taiwan)
- P-208 The relation between acupuncture points and sounds when treating children**
Taiji Misumi (Mikado Clinic, Japan)
- P-209 The efficacy and safety of periocular acupoint stimulation on myopia progression in children**
Hoyeaol Cha (Hospital of Korean Medicine, Pusan National University, Korea)
- P-210 Two cases report of Chinese herb medicine in treating children infectious aphthae ulcer**
Yi-Chiao Lee (Dept. Chinese Medicine, Kaohsiung Chang Gung Memorial Hospital, Taiwan)
- P-211 Noninvasive assessment of frailty in older patients with heart failure: the correlation between kampo-scores and “the timed ‘up and go’ test” and cardiovascular indices with doppler echocardiography.**
Kazunari Ozaki (Dept. Geriatric Medicine, Itami City Hospital, Japan)
- P-212 Characteristics of traditional Chinese medicine use in patients with Alzheimer’s disease in Taiwan: A nationwide population based study**
Ching-Yuan Lai (Sch. Chinese Medicine, China Medical Univ., Taiwan)

- P-213 Clinical efficacy of indigo naturalis to treat mild-to-moderate psoriasis : A randomized, double-blind, placebo-controlled study**
Hui-Man Cheng (China Medical University Hospital China Medical Univ., Taiwan)
- P-214 Traditional Chinese medicine treatment for acne**
Chao-Tsung Chen (Chung Yuan Christian Univ., Taiwan)
- P-215 Treatment network of Chinese herbal medicine for acne**
Hsing-Yu Chen (Div. Chinese Internal Medicine, Center Traditional Chinese Medicine, Chang Gung Memorial Hospital, Taiwan)
- P-216 Korean Medicine Treatment for 107 female patients with Genital Warts : Retrospective Chart Review**
Eun Lee (Roadledam Korean Medical Clinic, Korea)
- P-217 An improved case of excessive sweating on palms in a 6-year-old girl by use of Sanmotsuogonto**
Koki Chiba (Dept. Traditional Japanese Medicine, School of Medicine, Faculty of Medicine, Toho Univ., Japan)
- P-218 The four cases of prurigo nodularis treated with the combination of Unseiin (溫清飲) and drugs for overcoming blood stagnation.**
Hiroshi Kakuto (Dept. East Asian Traditional Medicine, Ehime Prefectural Central Hospital, Japan)
- P-219 Demographic Characteristic of Patients with Polycystic Ovarian Syndrome Using Traditional Chinese Medicine : A Nationwide Population-Based Study**
Jui-Ying Chu (Branch Linsen and Chinese Medicine, Taipei City Hospital, Taiwan)
- P-220 Integration of traditional and modern medicine strategy for improved pregnancy outcome with in-vitro fertilization embryo transfer in protein s deficiency**
Fang-I Liao (Dept. Traditional Chinese Medicine, China Medical Univ. Hospital, Taiwan)
- P-221 The clinical effectiveness of Goshakusan (五積散), a traditional chinese medicine on the prognosis of delivery of pregnant women with cold state who have been postterm**
Asako Okamura (Tsukuba Central Hospital, Obstetrics Gynecology, Japan)

- P-222 An infertile woman who managed to get pregnant by combining Keishibukuryogan (桂枝茯苓丸) with acupuncture and moxibustion therapy**
Genki Shimizu (Dept. East Asian Traditional Medicine, Ehime Prefectural Central Hospital, Japan)
- P-223 Acupuncture in Patients with Osteoarthritis of the Knee**
Pu-Wei Hou (Dept. Chinese Medicine, China Medical Univ. Hospital, Taiwan)
- P-224 Effect of traditional Japanese herbal medicines for treatment of adhesive capsulitis of the shoulder**
Keita Miyanishi (Miyanishi Orthopaedics Rheumatology Clinic, Japan)
- P-225 Clinical effect of traditional Chinese medicine on knee pain: A nationwide population-based cohort study**
Yuan-Chun Lo (Dept. Chinese medicine, Changhua Christian Hospital, Taiwan)
- P-226 The Kampo therapy for various symptoms caused by the abnormality of cervical spine**
Michihiko Hirata (Hirata Pain Clinic, Japan)
- P-227 Analgesic effect of bee venom acupuncture and its mechanism on inflammatory pain in the rat model of collagenase-induced osteoarthritis: mediation by opioid & adrenergic receptors**
Byung-Kwan Seo (Dept. Acupuncture & Moxibustion, Coll. Korean Medicine, Kyung Hee Univ., Korea)
- P-228 Chouto-San (釣藤散) might be effective to cluster headache**
Takashi Mitsufuji (Dept. Neurol., Sch. Medicine, Saitama Medical Univ., Japan)
- P-229 Clinical evaluation of atypical facial pain and atypical dental pain treated with Kampo medicines**
Kojiro Yamaguchi (Dept. Oral Maxillofacial Surgery, Kagoshima Univ. Hospital, Japan)

Others

- P-230 Method of clinical reasoning using problem lists for teaching Kampo medicine**
Makoto Arai (Dept. Kampo Medicine, Tokai Univ. Sch. Medicine, Japan)

- P-231 Postgraduate education in Japanese acupuncture: A current survey of medical residents**
Yoshinobu Nakada (Dept. Kampo Medicine, Tokai Univ. Sch. Medicine, Japan)
- P-232 Tongue image analysis for Kampo traditional pattern diagnosis – the association between tongue image and fluid disturbance pattern**
Ryutaro Arita (Center Kampo Medicine, Keio Univ. Sch. Medicine, Japan)
- P-233 Association between teeth-marked tongue and central aortic blood pressure among community-dwelling Japanese men and women: The toon health study**
Kiyohide Tomooka (Dept. Public Health Juntendo Univ. Grad. Sch. Medicine, Japan)
- P-234 Characteristics of traditional Chinese medicine use for the elderly patients in Taiwan: A nationwide population-based study**
Yuan-Ching Liao (Dept. Chinese Medicine, China Medical Univ. Hospital, Taiwan)
- P-235 A systematic review of complementary and alternative medicine prevalence studies in Japan**
Yoshihiro Kaneko (Akita Univ., Grad. Sch. Medicine, Japan)
- P-236 New evidence based on TCM-ADR platform**
Ting-Syuan Wang (Asia Univ., Dept. Photonics Communication Engineering, Japan)
- P-237 A perspective of traditional medicine on correlation between long-term temporomandibular disorders and overall quality of life**
Tae Yoon Kim (Jaseng Hospital Korean Medicine, Korea)
- P-238 Relation between the five viscera "depression" or "anger"**
Takashi Masanori (Tokai Univ. Oiso Hospital, Japan)
- P-239 Pro-bone and anti--fateffect of arginine by the regulation of Wnt/ β -catenin signaling pathway in human bone marrow mesenchymal stem cells**
Seunghoon Lee (Kyung Hee Univ. Korean Medicine Hospital, Korea)
- P-240 A traditional herbal medication, Maekmoondong-tang, for cough: A systematic review and meta-analysis**
Kwan. Il Kim (Dept. Clin. Korean Medicine, Coll. Korean Medicine, Kyung Hee Univ., Korea)

- P-241 Inhibitory effects of Cheongsangbangpoong-tang on both inflammatory acne lesions and facial heat in patients with acne vulgaris: A randomized controlled trial protocol**
Kyuseok Kim (Dept. Ophthalmol. Otolaryngol. Dermatol., Coll. Korean Medicine, Kyung Hee Univ. Korean Medicine Hospital, Korea)
- P-242 Protective effect of Yeoldahanso-tang on radiation-induced oral mucositis in mice**
Kwang Seok Ahn (Dept. Sci. Korean Medicine, Coll. Korean Medicine, Kyung Hee Univ., Korea)
- P-243 Electro-acupuncture to treat gastroesophageal reflux disease: A study protocol for a randomized, patient and assessor-blinded, sham-controlled trial**
Hojung Lee (Kyung Hee University, Korean Medicine Hospital, Korean Medicine Center, Korea)
- P-244 Efficacy and safety of Myofascial-meridian Release Acupuncture (MMRA) for chronic neck pain: a study protocol for randomized, patient- and assessor-blinded, sham controlled trial**
Jungtae Leem (Korean Medicine Clinical Trial Center, Kyung Hee University, Korean Medicine Hospital, Korea)
- P-245 The suggestion of standard process in developing the questionnaire of pattern identification**
Eunsu Jang (Coll. Korea Medicine, Daejeon Univ., Korea)
- P-246 Effect of acupuncture for radioactive-iodine induced anorexia in thyroid cancer patients: A randomized double blinded sham controlled pilot study**
Ju-Hyun Jeon (Dept. Acupuncture & Moxibustion, Daejeon Korean Medicine Hospital, Daejeon Univ., Korea)
- P-247 Reliability and validity analysis of the instrument on pattern identifications for depression**
In Chul Jung (Dept. Oriental Neuropsychiatry, Coll. Korean Medicine, Daejeon Univ., Korea)
- P-248 The choice factors of korean medicine in middle and old age population: Focusing on pain region and level**
Hye Kyoung Jang (Clin. Trial Center in Daejeon Univ. Dunsan Korean Medicine Hospital, Korea)
- P-249 Control of restraint stress-induced depressive-like behaviors and corticosterone-induced neuronal damages by So-ochim-tang-gamibang, a Korean herbal medicine**
Jung Eun Choi (Coll. Korean Medicine, Daejeon University, Korea)

- P-250** **Effects of Shinchubogun-tang on symptom reduction in patients with intervertebral lumbar disc herniation: a retrospective observational study**
Eun Jung Lee (Coll. Korea Medicine, Daejeon Univ., Korea)
- P-251** **An attempt to evaluate traditional Chinese medicine treatments in the update of Japan Geriatrics Society guidelines**
Koh Iwasaki (Center Traditional Chinese Medicine Home Healthcare, Southern Tohoku General Hospital, Japan)
- P-252** **To develop a chemical profile analytical method Hyeonggaeyeongyo-tang Mix extract by HPLC-DAD and its anti-inflammatory effect**
Sung-Ok Moon (Natl. Develop. Inst. Korean Med. (NIKOM), Korea)
- P-253** **Analysis of the pulse wave resonance spectra during pregnancy stages**
Fun-jou Chen (Dev. Pulmonary Med. Criti. Care, Dept. Intern. Med., China Medical Univ. Hospital, Taiwan)
- P-254** **Using traditional Chinese medicine *Scutellaria barbata* D. Don against Multiple drug-resistant *Acinetobacter baumannii* infections: animal model**
Chin-Chuan Tsai (Sch. Chinese Medicine for Post-Baccalaureate, I-Shou Univ. E-DA Hospital)



CD-ROMでマスターする 舌診の基礎

著=高橋楊子

B5判／並製／88頁／定価…6,000円＋税

ひとりで学べる舌診教本で
舌診の鑑別能力を鍛える。

CD-ROMとの併用で、舌診の臨床応用力をアップ。

- ◆ 舌診の基礎と臨床応用法を詳説。
- ◆ 付属CD-ROMとの併用で、舌診を独習できる画期的なテキスト。
- ◆ 繰り返し学習することで、舌診の基礎をマスターできる。
- ◆ 著者は、中国の代表的な診断学研究室の出身で、確かな内容。

中医学を学ぶための雑誌『中医臨床』（季刊）ますます面白く、実用的な内容になっています。



東洋学術出版社

販売部：〒272-0823 千葉県市川市東菅野1-19-7-102 電話047-321-4428
フリーダイヤルFAX 0120-727-060 E-mail: hanbai@chuui.co.jp ホームページ <http://www.chuui.co.jp>

Autuhor Index

(JGS, The First Japan-Germany Joint Symposium on Kampo Medicine and Acupuncture)

Tomonori Abe	P-83	Hen-Hong Chang	P-204	Chiu-Yuan Chen	P-180
Tomonori Abe	P-84	Hen-Hong Chang	P-236	Chiy-Rong Chen	P-16
Atsuko Adachi	P-174	Hsiaoyun Chang	P-172	Chung-Yi Chen	P-74
Shigehisa Adachi	P-128	Jui-Shu Chang	P-54	Dion Chen	P-213
Takumi Adachi	P-29	Junten Chang	P-129	Fang-Pei Chen	P-164
Kwang Seok Ahn	P-242	Li-Ching Chang	P-60	Fang-Pey Chen	P-253
Marie Amitani	P-229	Ling-Shuo Chang	P-130	Fun-Jou Chen	P-253
Makoto Arai	P-230	Tung-Ti Chang	P-205	Guang-Wei Chen	P-180
Makoto Arai	P-231	Tung-Ti Chang	P-234	Guang-Wei Chen	P-7
Tetsuya Arai	P-51	Wen-Te Chang	P-102	Hong-Jhang Chen	P-177
Nobuo Araki	P-126	Ya-Min Chang	P-72	Hsing-Yu Chen	P-207
Nobuo Araki	P-228	Yin-Jen Chang	P-143	Hsing-Yu Chen	P-215
Ryutaro Arita	P-232	Yu-Hung Chang	P-145	Hui-Mei Chen	P-6
EunKyung Bae	P-134	Yuh-Ming Chang	P-78	Ih-Sheng Chen	P-36
Ka-Yeon Baek	P-252	Benjamin Chant	S1-4	Jhen-Yi Chen	P-17
Yong-Hyeon Baek	P-227	Seongwon Chant	KS-1	Jhen-Yi Chen	P-86
Yong-Hyeon Baek	P-34	Chi-Yuan Chao	P-7	Jia-Hua Chen	P-225
Masashi Beppu	P-92	Chia-Ling Chao	P-152	Jing-Ming Chen	TS-3
Aleksandr Boharnikov	P-110	Chiu-Hei Chao	P-180	Jing-Xiu Chen	P-164
Eric Brand	GL-1	Chiu-Hui Chao	P-7	Jiun-Rong Chen	P-42
Joon-Seok Byun	EL-5	Hung Chao	P-102	Li-Geeng Chen	P-58
SungHui Byun	P-43	Bao-jyi Chen	P-39	Li-Geeng Chen	P-97
SungHui Byun	P-44	Bor-Chyuan Chen	P-65	Li-Geeng Chen	P-99
Shao-Qing Cai	P-12	Bor-Chyuan Chen	P-160	Lih-Geeng Chen	P-93
Shao-Qing Cai	P-13	Chao-Tsung Chen	TS-2	Lih-Geeng Chen	P-98
Silke Cameron	JGS-2	Chao-Tsung Chen	P-214	Lih-Lian Chen	P-132
Hoyeol Cha	P-209	Chi-Fang Chen	P-10	LiLi Chen	P-141
Chi-Chang Chang	P-64	Chien-Chieh Chen	P-23	Lin-Tzn Chen	P-170
Chi-I Chang	P-16	Chien-Lin Chen	P-17	Mei-Chuan Chen	P-80
Chia-Jung Chang	P-97	Chien-Lin Chen	P-21	Ming-Yen Chen	P-26
ChihHung Chang	P-141	Chien-Lin Chen	P-86	Po-Hsun Chen	P-1
Ching-Wen Chang	P-48	Chih-Fang Chen	TS-5	Shih-Yin Chen	P-18
Chiu-Ming Chang	P-254	Ching-Hsiu Chen	P-151	Shih-Yin Chen	P-88
Hen-Hong Chang	P-1	Ching-Hsiu Chen	P-152	ShuiLien Chen	P-155
Hen-Hong Chang	P-130	Ching-Hsiu Chen	P-162	Ting-Yu Chen	P-185
Hen-Hong Chang	P-142	Ching-Hsiu Chen	P-167	Wang-Chuan Chen	P-24
Hen-Hong Chang	P-145	Ching-Hsiu Chen	P-170	Yen-Fu Chen	P-142
Hen-Hong Chang	P-191	Ching-Hsiu Chen	P-189	Yi-Hung Chen	P-123

Yi-Hung Chen	P-212	Jeong June Choi	P-249	Tsukasa Fueki	P-149
Yi-Hung Chen	P-31	Jun-Yong Choi	P-188	Tsukasa Fueki	P-217
Ying-Ling Chen	P-120	Jun-young Choi	P-239	Makoto Fujimoto	P-46
Ying-Ling Chen	P-225	Jung Eun Choi	P-249	Yoshihiro Fukuta	TM-1
Yong-Syuan Chen	P-70	WonWoo Choi	P-206	Takehiko Furuhashi	P-137
Yu-Hung Chen	P-130	You-Kyung Choi	P-148	Jerome Ganzon	P-98
Yu-Pei Chen	P-191	Yung-Hyun Choi	P-68	Ho-Yeon Go	P-165
Yun-Chieh Chen	P-25	YungHyun Choi	P-66	Ho-Yeon Go	P-206
Yun-Chieh Chen	P-39	Pei-Chi Chou	P-3	Ho-Yeon Go	P-214
DennisC.H. Cheng	P-9	Pei-Ying Chou	P-153	Namgyeong Go	P-121
Hao-Yuan Cheng	P-102	Hsueh-Ting Chu	P-236	Namgyeong Go	P-159
Hao-Yuan Cheng	P-40	Jui-Ying Chu	P-200	In-Hyuk Ha	P-237
Hsiang-Wen Cheng	P-179	Jui-Ying Chu	P-219	Keisuke Hagihara	JS-1
Hui-Man Cheng	P-213	Hung-Yi Chuang	P-109	Keisuke Hagihara	P-83
Wan-Chun Cheng	P-104	Kuo-Hsiang Chuang	P-185	Keisuke Hagihara	P-84
Yun-Fang Cheng	P-23	Tzu-Yun Chuang	P-190	Klaus Hambrecht	EL-1
Chunhoo Cheo	P-94	Wei-Hsiang Chuang	P-42	Chang Han	P-237
Jen-Huai Chiang	P-65	Wu-Chang Chuang	P-101	Gajin Han	P-243
Jen-Huai Chiang	P-212	Li-Min Chueh	P-3	Gajin Han	P-244
Pei-Hsuan Chiang	P-23	Cheng-Ying Chung	P-168	Kyeong Han-Kim	P-165
PeiJung Chiang	P-141	Hsuan-Fu Chung	P-179	Tetsuo Hara	P-166
Su-Yin Chiang	P-15	JING-GUNG Chung	P-15	Yasushi Hara	P-112
Koki Chiba	P-149	Yu-Chu Chung	P-190	Naoyuki Harada	P-194
Koki Chiba	P-217	Jian-Ruei Ciou	P-130	Makoto Hashiguchi	P-217
Shu-Chen Chien	P-153	Yi Dai	P-30	Mizuki Hashimoto	P-111
Wen-Fed Chiou	EL-8	Gary Deng	IL-2	Akimune Hayashi	P-181
Chuan-Sung Chiu	P-25	Jeng-Shyan Deng	P-54	Hidetoshi Hayashi	P-84
Yung-Jia Chiu	P-39	Shun-Xin Deng	P-93	In Heo	P-135
Chong-Kwan Cho	P-246	Moonho Do	P-249	Kwang-Ho Heo	P-135
IlJe Cho	P-43	Ulrich Eberhard	JGS-1	Ko Heung	P-158
IlJe Cho	P-44	Eri Eguchi	P-233	Yasuyo Hijikata	P-195
Jae-Hyun Cho	P-188	Dongmyung Eom	P-4	Hiroaki Hikiami	P-46
JungHyO Cho	P-158	Dongmyung Eom	P-90	Michihiko Hirata	P-224
Nae-kyoung Cho	P-216	Young-Gyu Eun	P-242	Michihiko Hirata	P-226
Taehwan Cho	P-113	Chia-kwung Fan	P-52	Yasuyuki Hirose	EL-9
Do-Young Choi	KS-5	Yao-Fan Fang	P-142	Akiko Hirota	KS-3
Go-ya Choi	P-96	Tsukasa Fueki	P-92	Hsiu-O Ho	P-100
Inhwa Choi	P-116	Tsukasa Fueki	P-127	Yuji Hobo	P-232
Jeong June Choi	P-248	Tsukasa Fueki	P-128	Kengyo Hond	P-126

Jin-Im Hong	P-89	Ching-Jen Huang	P-132	Kan'ichiro Ishiuchi	P-91
MiNa Hong	P-188	Ching-wen Huang	P-94	Hachiro Isobe	P-199
SuHyun Hong	P-66	Chung-Yu Huang	P-37	Hideyuki Isobe	P-114
SuHyun Hong	P-68	Guan-Jhong Huang	P-53	Hideyuki Isobe	P-199
Yuko Horiba	P-193	Guan-Jhong Huang	P-54	Hideyuki Isobe	P-228
Yuko Horiba	P-232	Hsiang-Yun Huang	P-164	Hirohisa Isogai	P-117
Nobukazu Horie	P-174	Hsiu-Chen Huang	P-38	Hidetoshi Itakura	P-149
Mark C. Hou	P-120	Hsiu-chen Huang	P-77	Hidetoshi Itakura	P-217
Mark C. Hou	P-129	Huei-mei Huang	P-52	Takashi Ito	P-156
Mark C. Hou	P-225	Jing-Bin Huang	P-86	Toshinori Ito	GL-3
Pu-Wei Hou	P-223	Pin-Chen Huang	P-154	Ko Iwasaki	P-251
Wen-Chi Hou	P-16	Shu-Ming Huang	P-19	Ya-Min Jan	P-213
Wen-Chi Hou	P-20	Shu-Yun Huang	P-11	Bo-Hyoung Jang	P-94
Wen-Chi Hou	P-155	Shu-Yun Huang	P-202	Eunsu Jang	P-245
Jer-Yiing Houg	P-64	Shyh-Shyun Huang	P-53	Eunsu Jang	P-250
Li-Yu Hsiao	P-150	Shyh-Shyun Huang	P-54	Heewon Jang	P-90
Yu-Chen Hsiao	P-7	Ting-Yi Huang	P-168	Hye Kyoung Jang	P-248
Ching-Liang Hsieh	P-176	Tse-Hung Huang	S1-2	KyungHwan Jegal	P-43
Chiu-Lan Hsieh	P-19	Tzu-Ping Huang	P-234	Chan-Yong Jeon	P-148
Yi-Hsien Hsieh	P-67	Wen-Chih Huang	P-42	Jin-Woo Jeong	P-68
Yi-Hsien Hsieh	P-72	Yi-Chia Huang	P-131	Ju-Hyun Jeon	P-246
Yi-Hsien Hsieh	P-73	Yu-Chuen Huang	P-124	Zhixia Jiang	P-51
Yi-Hsien Hsieh	P-76	Yu-Chuen Huang	P-18	Song Jichung	P-90
Chih-Chieh Hsu	P-23	Yu-Chuen Huang	P-204	Mirim Jin	P-249
Chung-Hua Hsu	P-200	Jeong-Eun Huh	P-239	Daeyun Jo	P-239
Chung-Hua Hsu	P-219	Chih-Hsin Hung	P-254	Michiko Jo	P-45
Hsia-Fen Hsu	P-64	Yu-Chiang Hung	P-138	Michiko Jo	P-46
Li-Sung Hsu	P-78	Deok-Sang Hwang	P-183	Hwan-Soo Joo	P-237
Po-Chi Hsu	P-18	Eui-Hyoung Hwang	P-135	Mei-Tian Jou	P-2
Po-Chi Hsu	P-204	Man-Suk Hwang	P-135	Young-Sung Ju	P-96
Wei-Hsiang Hsu	P-177	LyunKi Hyun	P-183	Aram Jung	P-209
Miao-Lin Hu	P-19	MINKYUNG HYUN	P-136	Daewoong Jung	P-125
Nian-Ze Hu	P-225	Rie Iijima	P-87	In Chul Jung	P-246
Po-An Hu	P-47	Yusuke Inoue	P-174	In Chul Jung	P-247
Wen-Long Hu	P-138	Akio Inui	LS-1	In Chul Jung	P-248
Wen-Long Hu	P-203	Akio Inui	P-229	In Chul Jung	P-249
Steven Kuan-Hua Huan	P-161	Tomoaki Ishida	P-83	In Chul Jung	P-250
C. Chris Huang	P-213	Tomoaki Ishida	P-84	Ji-Yun Jung	P-43
Cheng Huang	P-38	Kan'ishiro Ishiuchi	P-87	Ji-Yun Jung	P-44

Ki-Yong Jung	P-148	Kyuseok Kim	P-116	Toru Konishi	P-51
Woo-Sang Jung	P-206	Kyuseok Kim	P-241	Toru Konishi	P-63
Mitsuru Kageyama	P-211	Me-riong Kim	P-237	Yoshinari Kono	P-149
Akina Kagioka	P-29	Sang-Hyuk Kim	KS-2	Yoshinari Kono	P-217
Hiroshi Kakuto	P-106	SangChan Kim	P-43	Bernd Kostner	EL-4
Hiroshi Kakuto	P-218	SangChan Kim	P-44	Bernd Kostner	JGS-1
Hiroshi Kakuto	P-222	Seunghyung Kim	P-249	HuaSheng Kou	P-112
Sharon Kam	P-109	Sookyung Kim	P-105	Ai Kouchi	P-114
Aki Kanazawa	P-61	Sungchul Kim	P-246	Ai Kouchi	P-199
hiroshi Kanda	P-103	Sungha Kim	P-134	Masayasu Koyama	P-211
Maria Kaneko	P-46	Sun Yeou Kim	P-249	Yuto Kubo	P-51
Yoshihiro Kaneko	P-235	Tae-Yoon Kim	P-237	Haruaki Kubota	P-59
Yukio Kaneko	P-137	Young-Sik Kim	P-96	Kenny Kuchta	EL-3
Kyung-Hwa Kang	P-14	YoungWoo Kim	P-44	Kenny Kuchta	JGS-2
Kyung-Rae Kang	P-237	Mari Kimura	P-45	Hiroshi Kuge	P-108
Wee-Chang Kang	P-247	Mari Kimura	P-46	Chih-Ying Kuo	P-151
Chiu-Li Kao	P-74	Yoko Kimura	P-156	Chun-Chi Kuo	P-71
Chun-Pin Kao	P-25	Yoko Kimura	S3-3	Hsiang-Chun Kuo	P-37
Shung-Te Kao	P-213	Mika Kina	P-59	Tai-Wei Kuo	P-120
Shiro Kato	P-221	Yuki Kishida	P-83	Tai-Wei Kuo	P-225
Kenji Kawakita	P-163	Yuki Kishida	P-84	Yi-Ting Kuo	P-65
Nagasaka Kazuhiko	P-201	Seong-Gyu Ko	S3-1	Yu-Jui Kuo	P-15
Wei-Ming Ke	P-153	Seong-Gyu Ko	P-94	SeungWon Kwon	P-206
Wei-Ming Ke	P-161	Seong-Gyu Ko	P-116	Chiensho Lai	TM-3
Zhu-Xin Ke	P-47	Seong-Gyu Ko	P-148	Ching-Yuan Lai	P-212
Chen Ke-Min	P-78	Seong-Gyu Ko	P-165	Jung-Nien Lai	EL-7
Tomokazu Kikuchi	P-114	Seungwoo Ko	P-148	Jung-nien Lai	P-157
Tomokazu Kikuchi	P-126	Youme Ko	P-165	Shih-Chan Lai	P-78
Tomokazu Kikuchi	P-199	Youme Ko	P-94	Richard S. Lavin	P-144
Byung-Jun Kim	P-135	Fumina Kobayashi	P-147	Beom-Joon Lee	P-240
Eunmi Kim	P-125	Kaori Kobayashi	P-174	Chen-chen Lee	P-52
In-Tae Kim	EL-6	Junichi Koeda	P-182	Chia-Jung Lee	P-61
JaeKwang Kim	P-43	Toshiaki Kogure	P-194	Chia-Jung Lee	P-97
JinOk Kim	P-183	Yoko Kogure	P-30	Chia-Jung Lee	P-99
Jong-Bum Kim	P-252	HiroshiB. Koide	P-163	Ching-Kuo Lee	P-49
Jung-Hoon Kim	P-96	Hiroshi Koike	P-193	Eun Lee	P-216
Kibong Kim	P-209	Kyung-hwan Kong	P-148	Eun Jung Lee	P-245
Kwan-Il Kim	P-240	Moonkyoo Kong	P-183	Eun Jung Lee	P-246
Kwan-Il Kim	P-241	Moonkyoo Kong	P-242	Eun-kyoung Lee	P-94

Gichan Lee	P-125	Shih-Chang Lee	P-180	Hsiang-Ling Lin	P-210
Guem-San Lee	P-96	Suk-Hoon Lee	P-246	Hui-Ju Lin	P-18
HanGyul Lee	P-206	Tsung-chieh Lee	P-173	Hung-Jen Lin	P-139
Hojung Lee	P-243	Tzong-Huei Lee	P-69	Hung-Yi Lin	P-124
Hun-Soo Lee	P-247	Wan-ju Lee	P-157	Jane-Ming Lin	P-18
Hwa-Dong Lee	P-252	Yi-Chiao Lee	P-210	Jaung-Geng Lin	TS-S
HyeYun Lee	P-188	Yi-Shan Lee	P-20	Jaung-Geng Lin	P-9
Hyujung Lee	IL-3	Yongho Lee	P-121	Jaung-Geng Lin	P-15
Hyun-Jong Lee	KS-6	Yongho Lee	P-159	Jaung-Geng Lin	P-124
Jae-dong Lee	P-239	Yu-Chen Lee	P-122	Jaung-Geng Lin	P-212
Jee-Young Lee	P-183	Yueh-lun Lee	P-52	JunDai Lin	P-141
Ji-Bum Lee	P-252	Jungtae Leem	P-243	Li-Wei Lin	P-22
Jia-Hao Lee	P-49	Jungtae Leem	P-244	Li-Wei Lin	P-24
JiHye Lee	P-188	Yu-Jie Lei	P-18	Li-Wei Lin	P-24
Jihyun Jihyun	P-121	Fong-Yu Li	TS-4	Li-Wei Lin	P-60
Jihyun Lee	P-159	Te-Mao Li	P-7	Lie-Chwen Lin	P-38
Jinho Lee	P-237	Te-Mao Li	P-180	Lie-Chwen Lin	P-95
Jong-Rok Lee	P-55	Tsai-Chung Li	P-140	Mei-Hsiang Lin	P-69
Jung-woo Lee	P-242	Tsai-Chung Li	P-141	Ming-Kuem Lin	P-102
Junhee Lee	P-240	Tsai-Chung Li	P-213	Su-Chin Lin	P-189
Junhee Lee	P-241	Fang-Yu Liang	P-35	Wang-Rong Lin	P-53
Junhee Lee	P-242	Shinn-Jye Liang	P-253	Wei-Yong Lin	P-85
Junhee Lee	P-243	Wen-Li Liang	P-154	Yen-Fong Lin	P-17
Junhee Lee	P-244	Wen-Li Liang	P-97	Yi-Chun Lin	P-205
Kun-Ta Lee	P-176	Fang-I Liao	P-220	Yi-Hsuan Lin	P-207
Kyoung-yeob Lee	P-216	Hou-Hsun Liao	P-65	Yi-Hung Lin	P-191
Mei-Hsien Lee	P-35	Hou-Hsun Liao	P-160	Yi-Rong Lin	P-5
Mei-Hsien Lee	P-36	Jiunn-Wang Liao	P-21	Yi-Tzu Lin	P-37
Mei-Hsien Lee	P-37	Jung-Chun Liao	P-25	Yi-Wen Lin	P-27
Mei-Hsien Lee	P-132	Tzu-Tung Liao	P-36	Yi-Wen Lin	P-28
Meng-Shiou Lee	P-102	Yuan-Ching Liao	P-234	Yi-Wen Lin	P-176
Min-Soo Lee	P-237	Che-Chen Lin	P-160	Yii-Jeng Lin	P-177
Ming-Chung Lee	P-101	Cheng-Che Lin	P-109	Yin-Shiou Lin	P-16
Nara Lee	P-240	Cheng-Wei Lin	P-69	Ying-Chih Lin	P-25
Sanghun Lee	P-134	Chi-Shiuan Lin	P-254	Yu-Chi Lin	P-162
Seung-Ho Lee	P-96	Chia-Liang Lin	P-72	Yu-Chi Lin	P-167
Seunghoon Lee	P-239	Chin-Hung Lin	P-81	Yu-Chih Lin	P-25
Seungmin Kee	P-244	Chu-Liang Lin	P-67	Yu-Chin Lin	P-48
Shih-Chang Lee	P-7	Chu-Liang Lin	P-73	Yu-Chun Lin	P-145

Yu-Min Lin	P-33	Toshiaki Makino	P-91	Hidetoshi Mori	P-108
Yun-Hua Lin	P-47	Toshiaki Makino	P-92	Akinori Morinaga	P-229
Yun-Lian Lin	P-177	Akio Manabe	S1-3	Akira Morita	P-147
Yun-Lian Lin	P-177	Yi-Wen Mao	P-35	Akira Morita	P-184
Xue-Hua Ling	P-64	Yi-Wen Mao	P-36	Hiroie Motoyama	P-117
Jing-Ping Liou	P-80	Kazuo Maruyama	P-111	Yusuke Mukai	P-111
Chi-Ming Liu	P-74	Kazuo Maruyama	P-146	Yoshito Mukaino	P-117
Chia-Yu Liu	P-200	Koutatsu Maruyama	P-233	Chiaki Murayama	P-57
Chia-Yu Liu	P-219	Kashima Masayuki	JGS-1	Kazuhiro Muroga	P-144
Ching-Wen Liu	P-60	Shoko Masuyama	P-115	Kazuhiro Muroga	P-198
Huan-Ting Liu	P-18	Satoshi Masuzugawa	P-137	Yasutaka Nagachi	P-13
Hui-Kang Liu	P-82	Hiroshi Matsuda	P-126	Kazuko Nagamura	P-182
Keng-Fan Liu	P-39	Tadashi Matsuda	P-175	Mahiko Nagase	P-112
San-Jung Liu	P-202	Yoshizumi Matsukawa	P-133	Yutaka Nagata	P-201
Shih-Ping Liu	P-18	Takanori Matsuoka	P-8	Yoshiko Naito	P-127
YAN-JIN Liu	P-15	Takanori Matsuoka	P-92	Yoshiko Naito	P-128
Yen-Wenn Liu	P-23	Takanori Matsuoka	P-127	Yoshinobu Nakada	P-230
Lun-Chien Lo	P-173	Takanori Matsuoka	P-128	Yoshinobu Nakada	P-231
Lun-Chien Lo	P-204	Takanori Matsuoka	P-149	Toshiya Nakaguchi	P-147
Yi-Ching Lo	P-32	Takanori Matsuoka	P-217	Yasuo Nakahara	OP-2
Yi-Ching Lo	P-74	Toshihiro Matsuzaki	P-59	Katsunori Nakamura	PL-1
Yuan-Chun Lo	P-129	Nai-Wen Mei	P-22	Michimi Nakamura	P-147
Yuan-Chun Lo	P-225	Masayuki Mikage	P-12	Yoshio Nakamura	P-211
Bernice Lottering	P-123	Noriko Mikami	P-182	Yuuki Nakamura	P-169
Ching-Hsing Luo	P-168	Masaaki Minami	P-51	Junko Nakasone	P-59
Xuesheng Ma	P-123	Masaaki Minami	P-63	Hideyuki Nakata	JS-4
Yi-Chun Ma	P-124	Takashi Mine	P-196	Yukiko Nakatsuka	P-46
Yi-Shih Ma	P-75	Taiji Misumi	P-208	Takashi Nakayama	P-144
Toshiaki Makino	JGS-2	Takashi Mitsufuji	P-228	Atsushi Nakazawa	P-193
Toshiaki Makino	PL-2	Oto Miura	P-149	Dongwoo Nam	S1-1
Toshiaki Makino	S2-1	Oto Miura	P-217	Dongwoo Nam	P-239
Toshiaki Makino	P-12	Keisuke Miyamoto	P-29	Dongwoo Nam	P-244
Toshiaki Makino	P-13	Keita Miyanishi	P-224	Takao Namiki	P-92
Toshiaki Makino	P-29	Junji Miyazaki	P-108	Takao Namiki	P-144
Toshiaki Makino	P-51	Yorikazu Mizoi	P-228	Takao Namiki	P-147
Toshiaki Makino	P-63	Hajime Mizukami	P-29	Takao Namiki	P-184
Toshiaki Makino	P-83	Kaito Mizuno	P-111	Takao Namiki	TM-5
Toshiaki Makino	P-84	Hobin Moon	P-105	Kazuhiko Nara	P-149
Toshiaki Makino	P-87	Sung-Ok Moon	P-252	Kazuhiko Nara	P-217

Atsushi Niizawa	P-174	Jong-Hyeong Park	P-148	Yui Sasaki	P-148
Takeshi Nikawa	P-83	Jong-Ju Park	P-165	Hiroshi Sato	SL-1
Takeshi Nikawa	P-84	Kyeongmee Park	P-113	Sven Schröder	LS-2
Fumino Ninomiya	IL-4	Sang-Mi Park	P-44	Takashi Seki	P-163
Fumiko Nishimori	P-133	SangMi Park	P-43	Takeshi Seki	JGS-3
Ko Nishimura	P-111	SeongHa Park	P-188	Byung-Kwan Seo	P-227
Tatsuya Nogami	P-46	Sook-Jahr Park	P-50	Byung-Kwan Seo	P-34
Katsuhiko Noguchi	P-59	Sunju Park	P-165	Hsueh-Hung Shao	P-22
Koichi Noguchi	P-30	Yang-Chun Park	P-248	Hsuan-Shu Shen	P-187
Hisayoshi Norimoto	P-57	Yang-Chun Park	P-249	Li-Ling Shen	P-143
Yukari Nose	P-111	Yeon-Cheol Park	P-227	Young-Ji Shiao	P-82
Takehiro Numata	GL-2	Yeon-Cheol Park	P-34	Naotoshi Shibahara	P-45
Dal-Suk Oh	P-158	YuLee Park	P-94	Naotoshi Shibahara	P-46
HyeKyung Oh	P-183	Ching-Tien Peng	P-124	Eri Shibata	P-221
Shuji Ohno	PL	Wen-Huang Peng	P-25	Ying-hua Shieh	P-52
Masahiro Ohsawa	P-29	Wen-Huang Peng	P-39	Chun-Chuan Shih	P-171
Masahiro Ohsawa	P-91	Wen-Huang Peng	P-48	Chun-Chuan Shih	TS-1
Takeshi Oji	P-147	Wen-Huang Peng	P-102	Kuei-Feng Shih	P-152
Hideki Okamoto	P-147	Anton Ponomarev	P-110	Hirobumi Shimada	P-147
Hideki Okamoto	P-184	Natalia Ponomarev	P-110	Yutaka Shimada	P-46
Kouichiro Okamoto	P-166	Pavel Ponomarev	P-110	Genki Shimizu	P-106
Asako Okamura	P-221	Yury Ponomarev	P-110	Genki Shimizu	P-218
Yuse Okawa	P-106	Hiromi Rakugi	P-211	Genki Shimizu	P-222
Toshimichi Oki	P-229	Hans Rausch	EL-10	Byung-Cheul Shin	P-135
Noriyuki Okisu	P-232	Hans Rausch	JGS-2	Joon-Shik Shin	P-237
Kazuhiro Oribe	P-224	Heidrun Reißerweber-Hewel		Sangho Shin	P-116
Kayo Osada	P-221		EL-2	Seungwon Shin	P-240
Misato Ota	P-12	Young-Beom Rho	KS-7	Soon-Shik Shin	S2-3
Misato Ota	P-13	HanSung Ryu	P-183	Yong-Cheol Shin	P-94
Kazunari Ozaki	P-211	Koichi Ryu	P-147	Hisashi Shinbara	P-119
Tai-Long Pan	P-41	Koichi Ryu	P-184	Maiko shirai	P-108
Li-Heng Pao	P-102	Isao Saito	P-233	Seiko Shirai	P-161
Cheol Park	P-68	Masayoshi Saito	P-61	Shinlei Shou	TM-2
Chiyong Park	P-125	Makiko Sakanashi	P-59	Masumi Shozu	P-174
Dae-Myung Park	P-249	Matao Sakanashi	P-59	Tatsuya Shudo	P-211
HyeLim Park	P-188	Mayuko Sakanashi	P-59	Masayoshi Soma	P-144
Jeong-Hwan Park	P-107	Hong SangHoon	P-158	Chang-Gue Son	P-158
Jeong-Hwan Park	P-134	Kazuro Sasaki	P-111	Jaemin Son	P-249
Jong-Hoon Park	P-237	Yui Sasaki	P-94	Jichung Song	P-4

Michael Song	P-213	Kinuko Takeshima	P-221	Yu-Ting Tseng	P-32
Sungmoon Song	P-125	Yasushi Takeya	P-211	Hsiao-Ling Tsou	P-11
Tuzz-Ying Song	P-17	Masahiro Tamano	P-221	Hsiao-Ling Tsou	P-202
Tuzz-Ying Song	P-21	Naotoshi Tamura	P-228	Yoshiki Tsujioka	P-106
Tuzz-Ying Song	P-86	Koichiro Tanaka	P-149	Nobuhiro Tsukada	P-193
Takuro Sonoda	P-226	Koichiro Tanaka	P-217	Koki Tsuruoka	P-235
Takuro Sonoda	P-229	Koichiro Tanaka	P-92	Kiichiro Tsutani	P-119
Chun-Jen Su	P-168	Nami Tanaka	P-221	Kiichiro Tsutani	P-163
Shan-Yu Su	P-139	Takeshi Tanigawa	P-233	Kiichiro Tsutani	P-235
Shan-Yu Su	P-143	Tatkeshi Tatsumi	P-194	Masato Tsutsui	P-59
Yi-Chang Su	P-131	Kousoku Tei	TM-4	Tadanori Tsuzaki	P-199
Yi-Chang Su	P-140	Isamu Tengan	P-112	Chia-Wen Tung	P-47
Yi-Chang Su	P-141	Hitoshi Teramoto	JS-3	Kazuo Uebaba	P-112
Mayuko Sugi	P-29	Haruyuki Toda	P-232	Yukiko Ueda	P-144
Tsuyoshi Sugiura	P-229	Yasuhito Todokoro	P-112	Takashi Uno	P-61
Akinori Sugiyama	P-91	Toshihiro Togo	P-119	Chin-Min Wang	P-11
Megumi Sumino	P-92	Kiyohide Tomooka	P-233	Ching-Chiung Wang	P-52
Mao-Feng Sun	P-3	Chin-Chuan Tsai	P-24	Ching-Chiung Wang	P-57
Mao-Feng Sun	P-9	Chin-Chuan Tsai	P-60	Ching-Chiung Wang	P-58
Mao-Feng Sun	P-10	Chin-Chuan Tsai	P-254	Ching-Chiung Wang	P-61
Mao-Feng Sun	P-160	Fan-Shiu Tsai	P-22	Ching-Chiung Wang	P-97
Mao-Feng Sun	P-212	Fan-Shiu Tsai	P-60	Ching-Chiung Wang	P-98
Mao-Feng Sun	P-234	Fuu-Jen Tsai	P-18	Ching-Chiung Wang	P-99
Seung-Ho Sun	P-148	Jen-Chieh Tsai	P-39	Ching-Chiung Wang	P-100
HyunKyung Sung	P-148	Li-Yao Tsai	P-100	Ching-Chiung Wang	P-153
Satoshi Suzuki	P-111	Ling-Ling Tsai	P-253	Ching-Chiung Wang	P-154
Toshiaki Suzuki	P-29	Ming-Yen Tsai	P-178	Ching-Chiung Wang	P-155
Yoshiaki Tabuchi	P-13	Ming-Yen Tsai	P-210	Ching-Chiung Wang	P-161
Shinji Tagami	JS-2	Po-Wei Tsai	P-58	Ching-Chiung Wang	S2-2
Chen-Jei Tai	S3-2	Show-Wen Tsai	P-19	Jiun-Chuan Wang	P-254
Chen-Jei Tai	P-153	Tung-Hu Tsai	P-62	Kun-Teng Wang	P-101
Yuji Taira	P-59	Ya-Chieh Tsai	P-99	Mei-Hua- Wang	P-186
Tetsuya Takada	P-192	Ying-Chieh Tsai	P-23	Pei-Wen Wang	P-41
Mitsuyuki Takamura	P-111	Yun-Ning Tsai	P-140	Qingmin Wang	P-213
Mitsuyuki Takamura	P-146	Huey-Jen Tsay	P-82	Shenglan Wang	P-30
Masanori Takashi	P-231	Chia-Yi Tseng	P-81	Ting-Hao Wang	P-210
Masanori Takashi	P-238	Hsuan-Ching Tseng	P-9	Ting-Syuan Wang	P-236
Shin Takayama	GL-2	Sung-Hui Tseng	P-155	Xijun Wang	S2-4
Shin Takayama	P-251	Ying-Jung Tseng	P-138	Yeh-Han Wang	P-18

Kenji Watanabe	P-192	Akio Yagi	P-184	Chia-Chou Yeh	P-65
Kenji Watanabe	P-193	Shuji Yakubo	P-144	Mei-Ling Yeh	P-186
Kenji Watanabe	P-232	Hidetoshi Yamaguchi	P-127	Mei-Ling Yeh	P-190
Tadashi Watsuji	P-238	Hidetoshi Yamaguchi	P-128	Ming-Hsien Yeh	P-160
Tzog-Der Way	P-15	Kojiro Yamaguchi	P-229	Ming-Hsien Yeh	P-180
Chla-Li Wei	P-23	Satoru Yamaguchi	P-114	Ming-Hsien Yeh	P-65
shih-chin Wei	P-129	Satoru Yamaguchi	P-126	Wan-Ju Yeh	P-42
Chi-Luan Wen	P-16	Takara Yamami	P-106	Yueh-Chiao Yeh	P-47
Shu-Hui Wen	P-187	Takara Yamami	P-222	Hung-Rong Yen	P-65
Tsung-Kai Wen	TS-6	Atsushi Yamamoto	P-174	Hung-Rong Yen	P-160
Shu-Wen Weng	P-197	Kanoko Yamamoto	P-194	Hung-Rong Yen	P-205
Claudia Witt	JGS-3	Satoshi Yamamoto	P-30	Hung-Rong Yen	P-212
Yiu-Ming Wong	P-118	Toshimasa Yamamoto	P-228	Hung-Rong Yen	P-234
Chi-Rei Wu	P-22	Akiyoshi Yamanaka	P-137	Jui-Ting Yen	P-23
Chi-Rei Wu	P-24	Kazufumi Yamanaka	P-144	Kun-Ying Yen	IL-1
Chieh-Hsi Wu	P-213	Denichiro Yamaoka	P-106	Liang-Ta Yen	P-28
Chien-Chih Wu	P-161	Denichiro Yamaoka	P-218	Ayumu Yokochi	P-111
Chien-tung Wu	P-157	Denichiro Yamaoka	P-222	Kazumi Yokomizo	P-169
Ching-Yi Wu	P-162	Hitoshi Yamashita	JGS-3	Naomi Yokoyama	P-29
Ching-Yi Wu	P-167	Hitoshi Yamashita	P-106	Hwa-Seung Yoo	P-246
Fang-Chen Wu	P-173	Hitoshi Yamashita	P-115	Jungjeh Yoon	P-125
Han-Kuei Wu	P-142	Taketoshi Yamazaki	P-196	Jeungwon Yoon	P-246
Jhoa-Huei Wu	P-21	Chen-Cheng Yang	P-109	SeongWoo Yoon	P-183
Jing-Mei Wu	P-64	Chin-Tsang Yang	P-31	Kazuhiro Yoshida	P-149
Lung-Yuan Wu	P-24	Cholsong Yang	OP-1	Kazuhiro Yoshida	P-217
Lung-Yuan Wu	P-25	Hsin-Yi Yang	P-42	Tetsuhiro Yoshino	P-192
Lung-Yuan Wu	P-60	Jun Yang	P-27	Tetsuhiro Yoshino	P-232
Lung-Yuan Wu	P-81	Sien-hung Yang	P-207	Makoto Yoshitomi	KS-4
Lung-Yuan Wu	P-81	Su-Tso Yang	P-1	Okheui You	P-125
Pei-Chen Wu	P-177	Su-Tso Yang	P-5	Keiko Yukawa	P-119
Po-Long Wu	P-25	Su-Tso Yang	P-6	Keiko Yukawa	P-235
Tsung-Hsiu Wu	P-154	Su-Tso Yang	P-104	Younghee Yun	P-116
Tung-Yun Wu	P-80	Te-Fang Yang	P-76	Fuzi Zhang	P-91
Tzu-Hua Wu	P-69	Tien-Lin Yang	P-191	Jian-Rong Zhou	P-169
Wei-Hau Wu	P-16	Nami Yano	P-182	Jian-Rong Zhou	P-56
WeiWen Wu	P-186	Hiromichi Yasui	P-146	PeiQi Zhou	P-7
Yang-Chang Wu	P-213	Ke Ye	P-84	Shu-Mei Zhou	P-3
Yang-Chang Wu	P-79	Chia-Chou Yeh	P-160		
Akio Yagi	P-147	Chia-Chou Yeh	P-180		

Acknowledgements

The Organizing Committee of the 18th ICOM are grateful to the following organizations and companies for supporting the congress.

Okinawa Prefecture	The Federation of Pharmaceutical
Okinawa Convention Center	Manufactures' Associations of Japan
Goto College of Medical Arts and Sciences	SEIRIN CORPORATION
TSUMURA & Co.	Research Group for Kampo Medication
Kracie Pharmaceutical Ltd.	Based on Modern Science KOTARO
Kobayashi Pharmaceutical Co., Ltd.	PHARMACEUTICAL CO., LTD.
OHSUGI Pharmaceutical Co., Ltd.	Aoki Clinic
Toyodo Hijikata Clinic	Keinan Clinic
Ohirakai Medical Corporation,	Tokai Kampo Kyogikai
Minei Daiichi Hosiptal	Seikoen Hosono Clinic
Sun Ten Pharmaceutical Co., Ltd.	Asian Network Co., Ltd.
Mayado Seiyaku Co., Ltd.	ROHTO Pharmaceutical Co., Ltd.
Tochimoto Tenkaido Co., Ltd.	OMINEDO Co., Ltd.
Okinawa College of Integrated Medicine	DongBang Medical Co., Ltd.
Kubagawa Dermatology Clinic	Japan Kanpo Society
The Japan Kampo Medicine Association	JPS Pharmaceutical Co., Ltd.
Sanwa Shoyaku Co., Ltd.	Ryogen Co., Ltd.
Nitto Pharmaceutical Industries, Ltd.	Iskra Industry Co., Ltd.
INUBUSHI SEIYAKU Co., Ltd.	TOYO GAKUJUTSU PUBLISHER Co., Ltd.
Matsuya Pharmacy	MATSUURA YAKUGYO Co., Ltd.
Takeda Pharmaceutical Co., Ltd. Onchikai	Eisai Co. Ltd.
Kaneko Pharmacy	Uchidawakanyaku Ltd.
Suemori Clinic	And
Okinawa Pharmaceutical Association	Other Persons

Corporation

Board of Directors of International Society of Oriental Medicine (ISOM)

President

中田敬吾, Dr. Keigo Nakata, Japan

Vice presidents

陳 介甫, Dr. Chieh-Fu Chen, Taiwan、 金 弼建, Dr. Pil-Gun Kim, Korea

安井廣迪, Dr. Hiromichi Yasui, Japan

Secretary General

李 應世 Dr. Eung-Se Lee, Korea

Vice Secretary Generals

林 宜信 Dr. I-Hsin Lin, Taiwan、

李 鐘安 Dr. Jong-An Lee, Korea

牧野利明 Dr. Toshiaki Makino, Japan

Directors

宮崎瑞明 Dr. Zuimei Miyazaki, Japan、 大野修嗣 Dr. Shuji Ohno, Japan

東郷俊宏 Dr. Toshihiro Togo, Japan、 山下 仁 Dr. Hitoshi Yamashita, Japan

吉富 誠 Dr. Makoto Yoshitomi, Japan

卞 俊哲 Dr. Joon-Seok Byun, Korea、 金 鎬淳 Dr. Ho-Soon Kim, Korea

高 成奎 Dr. Seong-Gyu Ko, Korea、 朴 完洙 Dr. Wan-Su Park, Korea

施 振國 Dr. Chen-Kuo Shih, Korea

陳 俊明 Dr. Jing-Ming Chen, Taiwan、 黃 怡超 Dr. Yi-Tsau Huang, Taiwan

李 豐裕 Dr. Feng-Yu Li, Taiwan、 林 昭庚 Dr. Jaung-Geng Lin, Taiwan

王 靜瓊 Dr. Ching-Chiung Wang, Taiwan

Mr. Chan, Y.L., Abraham, Hong Kong, China

Dr. Ponomarev Yury, Russia

Dr. Flowers James, Australia

Dr. Mitiades Karavis, Greece

Directors of Japan Branch of ISOM

(List except for the Directors of ISOM and the members of Organization
Committee of the 18th ICOM)

津谷喜一郎 Dr. Kiichiro Tsutani、 永井良樹 Dr. Yoshiki Nagai

長坂和彦 Dr. Kazuhiko Nagasaka、 並木隆雄 Dr. Takao Namiki

齊藤宗則 Dr. Munenori Saito、 山岡傳一郎 Dr. Denichiro Yamaoka

高山真 Dr. Makoto Takayama、 大山雅義 Dr. Masayoshi Ohyama

**Traditional east asian medicine
Blessing of the earth is
the best gift for your health**



ウチダ和漢薬は
良質の生薬を
供給してまいります



株式会社ウチダ和漢薬
<http://www.uchidawakanyaku.co.jp>



Better Health, Brighter Future



タケダから、世界中の人々へ。
より健やかで輝かしい明日を。

武田薬品工業株式会社

www.takeda.co.jp



経典・処方箋医薬品：注意—医師等の処方箋により使用すること
アルツハイマー型、レビー小体型認知症治療薬 (薬価基準収載)

日本薬局方 ドネペジル塩酸塩錠
アリセプト 錠 3mg
錠 5mg
錠 10mg

日本薬局方 ドネペジル塩酸塩錠
アリセプト 錠 0.5%

アリセプト-D 錠 3mg
錠 5mg
錠 10mg
(ドネペジル塩酸塩口崩壊錠)

アリセプト 内服ゼリー 3mg
内服ゼリー 5mg
内服ゼリー 10mg
(ドネペジル塩酸塩内服ゼリー)

アリセプト ドライシロップ 1%
(ドネペジル塩酸塩内服液)

www.aricept.jp

●効能・効果、用法・用量、禁忌を含む使用上の注意等については添付文書をご参照ください。



エーザイ株式会社

東京都文京区小石川4-6-10

製品情報お問い合わせ先：

エーザイ株式会社 htcホットライン

フリーダイヤル 0120-419-497 9時～18時(土・日・祭日 9時～17時)

ART1408M01

香りで気を^{めぐ}回らせるくすり

Aromatic crude drugs adjust the autonomic nervous system.



麝香・牛黄・サフラン(番紅花)
沈香・人参・竜腦・甘松
桂皮・牛胆・丁子・木香
香附子・甘草・生姜

下記書籍にてご紹介
『日本の名薬』 『日本の伝統薬』
『妙薬探訪』 『文藝春秋 Special』



第2類医薬品

文政年間(1818~1830年)創製

犬伏製薬株式会社

徳島県板野郡藍住町東中富字東傍示64-6
〒771-1220 電話 (088) 692-2302

一般社団法人 日本漢方交流会

会長 木村孟淳

昭和43年創立 漢方を志す研究会9団体と全国の個人会員約400名で構成された組織です。

九州漢方研究会 京都漢方研究会 近畿鍼灸漢方研究会

熊本漢方研究会 東海漢方協議会 東京漢方教育研究センター

徳島和漢薬研究会 日中医薬研究会関東支部 広島漢方研究会

- ①毎年秋に全国学術大会を開催します。今年は10月9日10日で福岡大会をします。
- ②1月に一泊研修会として冬期合宿講習会を開催します。
- ③5月に慢性・難病フォーラムを新大阪駅近くのホテルで開催します。
- ④薬局経営から運用までを指導する漢方薬剤師育成研修会を毎年開催しています。
- ⑤初学者のための漢方運用講座を東京と新大阪で毎年2回開催しています。

東洋医学に関する研究の発展を図り、東洋医薬学の進歩普及に貢献し、会員の親睦を図り
国民の健康の増進と保持に寄与することを目的とした団体です。

ホームページ <http://www.kanpou.com/>

三大法則で解き明かす漢方・中医学入門

-基礎理論とエキス製剤による臨床-

梁哲成 著

B 5 本体 4,500 円+税/〒送料 460 円 (1 部) /ISBN: 978-4-89748-110-4

本書の特徴/①明快な基礎理論②豊富な症例で臨床疑似体験③練習問題で実力アップ④簡単臨床テクニックで即実践

中医学を学ぼうとする医師や薬剤師を対象に漢方・中医学の入門セミナーを実施してきた著者が、その講演資料を整理して著した。伝統的（後世派）漢方・中医学理論と臨床応用を出来る限り簡明に系統立てて解説し、豊富な症例を掲示。解説の漢方方剤は、殆どがエキス製剤として、保険収載されているものである。

わかる中医学入門

邱紅梅著/ISBN: 978-4-89748-089-3

A5・195 頁 本体 2,800 円+税

〒送料 300 円 (1 部)

東医雑録(1)～東医雑録(3)

[オンデマンド版]

山本巖著/A5 各 本体 9,000 円+税

〒送料無料(1)～(3)セット

/460 円(1部)

燎原書店/〒101-0051 東京都千代田区神田神保町 3-2-9 塚本ビル2F

TEL:03-6272-6145 FAX:03-6272-6146 <http://www.ryogen.jp/>

加工ブシ末とともに半世紀

original plant : aconite

医療用薬価収載品・劇薬

S-01 日局 **加エブシ末**「三和生薬」

— 効能・効果 —

強心、鎮痛、利尿

「効能・効果」「用法・用量」「使用上の注意」等については、製品添付文書をご参照下さい。

ハナトリカブト



北海道原料生産圃場

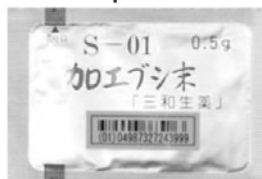

■ST-01 **アコニンサン錠** (加工ブシ末製剤)

●加工ブシ配合の医療用漢方製剤(10 処方)

S-02 真武湯 S-03 桂枝加朮附湯 S-04 八味地黄丸料
S-05 芍薬甘草附子湯 S-06 大防風湯 S-07 葛根加朮附湯
S-08 麻黄附子細辛湯 S-09 附子理中湯 S-10 桂芍知母湯
S-29 当帰芍薬散加附子

* 劇薬(アコニンサン錠、大防風湯・葛根加朮附湯の分包除く) *

●上記以外の医療用漢方製剤(26 処方)



三和生薬株式会社

<http://www.sanwashoyaku.co.jp/>

東京営業所 03-3834-2171 福岡営業所 092-573-5670

本社・工場(栃木県宇都宮市) 028-661-2411

原典に忠実なJPS漢方エキス

…自然の恵みを大切に活かし、人々の健康と社会に貢献する…



ジェーピーエス製薬は東洋医学の考え方を背景に『人間は自然と共にあり自然に生かされているという摂理に従い、病める人の身体の調和（バランス）を求めることによって病を治す』という漢方理論に基づいて医薬品の提供を行っています。

すべての人々が健康で幸せな毎日をおくことを願い、常に高品質で信頼される製品とサービスを提供することを通じて皆様の暮らしにより一層の貢献をしてまいりたいと考えています。

資料請求先



ジェーピーエス製薬

〒224-0023 神奈川県横浜市都筑区東山田 4-42-22

TEL 045-593-2060 FAX 045-593-2069 <http://www.jps-pharm.com/>

若甦
じやっこう

滋養強壮・虚弱体質に



日東薬品工業株式会社

www.nitto-pharma.co.jp



健康な暮らしのベストパートナー

摩耶堂製薬は家族と健康を応援する製薬会社です

更年期の男性の方へ



キンジャセイ
KINJYASEI

血糖の乱れによる諸症状に



糖解錠
TOKAIJYO

膀胱炎やムクミの諸症状に



腎仙散
JINSENSAN

関節や腰の痛みに



雲仙錠
UNZENJYO



摩耶堂製薬株式会社

サイエンス漢方処方研究会

Research group for Kampo medication based on modern science

事務局：静仁会静内病院 理事長：井齋偉矢 (science.kampo@gmail.com)



設立趣意書

超多成分系であることを除けば新薬と何ら変わりのない薬剤・・・科学的に理解して運用する方がはるかに有効かつ現実的な手段・・・漢方薬の科学的な位置づけを明確にし・・・作用機序の解明が必要にして不可欠・・・わが国および世界にその成果を情報として発信・・・人類の福祉に寄与

第1回：芍薬甘草湯シンポジウム

2012年3月18日 (名古屋市)

第2回：抑肝散(加陳皮半夏)シンポジウム

2013年1月13日 (日本経済大学)

第3回：麻黄湯・インフルエンザ シンポジウム

2014年3月23日 (日本経済大学)

第4回：The Best Case Study シンポジウム

2015年3月22日 (日本経済大学)

第5回：The Best Case Studyシンポジウム

2016年3月21日 (日本経済大学)

手^てに^に職^{しよく}技^{わざ}心^{こころ}

これからの 未来を支える統合医療

“統合医療”とは、精密検査などの分析的診断から投薬や手術の治療を中心とした西洋医学に、予防的概念を中心とした伝統医療を対等に取り入れていくという、新しいタイプの医療です。近年、この統合医療はますます重要視され、県内外でその従事者の育成とニーズが高まっています。そのため、鍼灸師・柔道整復師が持つ技術や知識を求めるフィールドも拡大し、安定性や将来性の高い分野であると言えます。さらに、鍼灸師・柔道整復師の仕事は社会貢献への欲も大きく、高い志を持つあなたにふさわしい活躍の場が待っています。



鍼灸学科



柔道整復学科



沖縄統合医療学院

Okinawa College of Integrative Medicine

〒901-2132 沖縄県浦添市伊祖4丁目1番19号



0120-873-104



心ある、そして考える医療人を育成します



学校法人後藤学園



東京衛生学園専門学校

厚生労働大臣認定・指定・専修学校認可

- 看護学科 二年課程・二年課程通信制
 - ★看護師 ※1
- リハビリテーション学科 1部
 - ★理学療法士 ※1
- 東洋医療総合学科 1部・2部
 - ★あん摩マッサージ指圧師・はり師・きゅう師 ※1

〒143-0016 東京都大田区大森北4-1-1
TEL 03-3763-6621 FAX 03-5763-7303
<http://www.teg.ac.jp/>



神奈川衛生学園専門学校

厚生労働大臣認定・指定・専修学校認可

- 東洋医療総合学科
 - ★あん摩マッサージ指圧師・はり師・きゅう師 ※1
 - ★アスレティックトレーナー(日本体育協会公認) ※2
 - ★健康運動実践指導者(健康・体力づくり事業財団認定) ※2
 - ★日本赤十字社救急法救急員
- 看護学科 ★看護師 ※1

〒238-0052 神奈川県横須賀市佐野町2-34
TEL 046-850-6310 FAX 046-850-6311
<http://www.keg.ac.jp/>

- 臨床教育専攻科
 - ★あん摩マッサージ指圧師・はり師・きゅう師の養成施設教員資格※3
- ※1 国家試験受験資格 ※2 受験資格 ※3 取得資格

- 入学資料無料送付
電話かホームページからご請求ください。
- 学校見学受付中(約1時間 事前予約制)

学校法人後藤学園 附属施設・研究所

【東京】

- 中医臨床センター ☎ 03-3763-8500
- マッサージ治療室 ☎ 03-6911-3650
- リンパ浮腫研究所 ☎ 03-6911-3054

【神奈川】

- 附属はりきゅう臨床施設 ☎ 046-850-6315
- 附属横浜国際プールはりきゅうマッサージ室 ☎ 045-592-1421

誰もが健康で、幸せに。
天然物を通じて世界中の人たちを幸せにしたい。
それが大峰堂の「心」です。

漢方薬へのこだわり、 一貫製造が生み出す感動品質。



- 五感を尽くして選び抜く、原料へのこだわり
- 漢方エキスを抽出する、多種多様な技術
- 充実した設備と人の力で生み出す高品質製剤
- 徹底した品質管理、安全・安心な製品



 大峰堂薬品工業株式会社

〒635-0051 奈良県大和高田市根成柿 574 番地 TEL 0745-22-3601 <http://www.ominedo.co.jp> info@ominedo.co.jp

[주]동방메디컬



Medical company,
carrying healthy energy.



DONGBANG
Medical Co., Ltd.

#313 WOORIM W-CITY, 9-22, PANGYO-RO 255BEON-GIL, BUNDANG-GU, SEONGNAM-SI,
GYEONGGI-DO, KOREA TEL +82-31-628-8145 FAX +82-31-707-0990

www.dbneedle.com

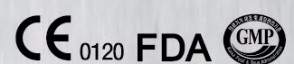

生薬に一意専心
わたしたちは大地の恵みを大切に活かし、
「人々の健康」と「自然に感謝する感性」の
創造を目指します。



株式会社杉本天海堂 柏原工場(兵庫県)

漢方薬の輸入・製造・販売を一貫して行う漢方専門総合卸です

株式会社 杉本天海堂

〒530-0053 大阪府大阪市北区末広町3番21号

[TEL] 06-6312-8425 [URL] <http://www.tochimoto.co.jp/>

漢方情報サイト

漢方薬の **きぐすり**.com [URL] <http://www.kigusuri.com/>

安心・安全への取り組み

- 残留農薬の管理
管理品目(有機塩素系・有機リン系・ピレスロイド系…合計451成分)
- 放射性物質の検査
国の基準に準じて放射能を測定。
- 種苗・栽培・加工管理
国内外の農家に協力を依頼し、原料を一元管理。
- 生薬資源の栽培化
資源の枯渇を防ぐために自社栽培を事業化。

ホットでもアイスでもおいしい杜仲茶。
色々な飲み方でお楽しみいただけます。

健康成分がたっぷり入った杜仲茶は、カフェインを含まないから、
ご家族どなたでも、毎日お飲みいただけます。



**外遊びや運動時の
水分補給に…**

お子さまには高カロリーのスポートドリンクよりも、
安心のノンカロリー、ノンカフェインで。



**レモン汁を絞って…
美容と健康に!!**

適量のレモン汁を絞れば、健康づくりは
もちろん、美容のためにも。



**ウイスキーや焼酎を
杜仲茶で割って…**

冷やした杜仲茶でウイスキーや焼酎を割っても
おいしくお飲みいただけます。

杜仲茶。

健康成分が「濃くて、おいしい」



健康の秘密は「杜仲葉のお茶」

杜仲の原産地である中国四川省の少数民族・チャン族は、杜仲葉をお茶にしたり料理に入れて常食しています。高脂肪、高カロリーな豚肉やヤギ肉などが中心の食生活が続けながら、チャン族は健康そのもの。その秘密は、杜仲にあるといわれています。



※当社比
杜仲葉の健康成分が約8倍!

経済的で煮出しやすいティーバッグ

経済的な
ティーバッグ

水から入れて
煮出せて便利!



とちゅう ちゃ
特撰 杜仲茶 60袋入

申込番号
51030 **¥3,150** (税込)

●内容量:3g×60袋 ■主成分/杜仲葉

独自の特許製法で、杜仲の健康成分(ゲニポシド酸)が約8倍摂れます。

◎栄養成分表示 杜仲茶1袋(3g)あたり

熱量	たんぱく質	脂質	炭水化物	ナトリウム
0kcal	0g	0g	0g	0mg
カフェイン	0mg	ゲニポシド酸	50~102mg	

水1.5Lに杜仲茶1袋(3g)を入れ、沸騰後10分間煮出した液について試験。

《保存上のご注意》煮出した杜仲茶は冷蔵庫で保存し、お早めにお飲みください。※当社比とは、弊社市販の杜仲茶の1.5g茶葉と特撰杜仲茶それぞれ1パックを、水で10分煮出したときの健康成分(ゲニポシド酸量)の比較。

中国・吉林省
長白山天池



漢方製剤

ジュンコウ

ほ ちゅう えっ き とう

FC 41T

補中益気湯

薬価基準収載

FCエキス錠 医療用

●効能・効果、用法・用量、使用上の注意等については製品添付文書をご覧ください。



人参栽培で有名な吉林省長白山。
標高2744mの山脈で、北朝鮮と国境をなす。長白林海と呼ばれる原生林が広がる広大な自然保護区となっている。
主峰の山頂には、世界で一番高い海拔に位置する『天池』と呼ばれる火山口湖がある。
水深300mの湖面は青く鏡のように澄みわたり、訪れた人々を幻想の世界に誘う。



ジュンコウ製品一覧(細粒)

温清飲	柴胡加龍骨牡蠣湯	半夏厚朴湯
黃連解毒湯	柴胡桂枝湯	半夏瀉心湯
乙字湯	四物湯	防己黃耆湯
葛根湯	芍藥甘草湯	補中益気湯
加味逍遙散	十全大補湯	麻黃湯
帰脾湯	小柴胡湯	麻杏甘石湯
芎藭膠艾湯	清心蓮子飲	薏苡仁湯
桂枝加芍薬湯	大柴胡湯	龍胆瀉肝湯
桂枝茯苓丸	桃核承気湯	苓桂朮甘湯
呉茱萸湯	当帰芍薬散	六味地黄丸
五苓散	麦門冬湯	

漢方を現代医療に生かす

オスギ

大杉製薬株式会社
<http://ohsugi-kanpo.co.jp>

資料請求先

営業本部 〒546-0035 大阪市東住吉区山坂 1-8-6 TEL(06)6629-9055(代)

(2015年2月制作)



KOTARO PHARMACEUTICAL introduced in 1957 the world's first Kampo extract preparations on the market. Later, in 1967, six of our preparations could be covered in Japan for the first time by the health insurance and after 1976 more than 100 of our preparations were used in hospitals and clinics. Now it is half a century since we put our Kampo extract preparations on the market and believe, we made a major contribution to this industry. In the future we intend to continue working in accordance with our company motto: "Still better Kampo for still more people" and provide pharmaceutical products of still higher quality.



Origin of the company's name

The company was named "KOTARO" by its founder Taro Ueda with reference to his birth place. Close to the ancient city of Nara. Kotaro is the name of an enormous sheer cliff, 700 m wide and about 200 m high. Mr. Ueda felt an affection rising to the heavens for this cliff and thus made it the company's name.

KOTARO PHARMACEUTICAL CO., LTD.

5-23 Nakatsu 2-Chome, Kita-ku, Osaka 531-0071, JAPAN

URL: <http://www.kotaro.co.jp>

Kracie

KEEPING PACE WITH THE TIMES,
MILD MEDICAL TREATMENT FOR HUMAN



Kracie KB-16 ハン ゲ コウ ボク トウ 半夏厚朴湯 3.0g	Kracie KB-41 ホ チュウ エツ キ トウ 補中益気湯 3.75g
Kracie KB-7 ハチ ミ ジ オウ ガン リョウ 八味地黄丸料 3.0g	Kracie KB-62 ボウ フウ ツウ ショウ サン リョウ 防風通聖散料 3.75g
Kracie KB-108 ニン ジン ヨウ エイ トウ 人參養栄湯 3.75g	Kracie KB-23 トウ キ シャク ヤク サン リョウ 当归芍薬散料 3.0g
Kracie KB-19 ショウ セイ リョウ トウ 小青竜湯 3.0g	Kracie KB-24 カ ミ ショウ ヨウ サン リョウ 加味逍遙散料 3.0g
Kracie KB-10 サイ コ ケイ シ トウ 柴胡桂枝湯 3.0g	Kracie KB-25 ケイ シ ブク リョウ ガン リョウ 桂枝茯苓丸料 3.0g

twice or three times a day, possible to select

Kracie EK 16 ハン ゲ コウ ボク トウ 半夏厚朴湯 2.0g	Kracie EK 41 ホ チュウ エツ キ トウ 補中益気湯 2.5g
Kracie EK 7 ハチ ミ ジ オウ ガン リョウ 八味地黄丸料 2.0g	Kracie EK 62 ボウ フウ ツウ ショウ サン リョウ 防風通聖散料 2.5g
Kracie EK 108 ニン ジン ヨウ エイ トウ 人參養栄湯 2.5g	Kracie EK 23 トウ キ シャク ヤク サン リョウ 当归芍薬散料 2.0g
Kracie EK 19 ショウ セイ リョウ トウ 小青竜湯 2.0g	Kracie EK 24 カ ミ ショウ ヨウ サン リョウ 加味逍遙散料 2.0g
Kracie EK 10 サイ コ ケイ シ トウ 柴胡桂枝湯 2.0g	Kracie EK 25 ケイ シ ブク リョウ ガン リョウ 桂枝茯苓丸料 2.0g



We wish you a healthy living

For more information, please contact

Kracie Pharmaceutical, Ltd.

20-20, Kaigan 3-chome, Minato-ku, Tokyo 108-8080

Printed in Dec.2009

<http://www.kampoyubi.jp>



順天堂



活力勇骨丸

古来より中国宮廷で親しまれていた最高の養生方

活力勇骨丸は中国の医学書である「医方考」を原典とした亀鹿二仙膠と同じ
処方で作られています（亀板、鹿角、枸杞子、人参）。

亀板は血を滋養し、鹿角は生命活動に必要なエネルギーを補います。加えて美容と長
寿に良いとされている枸杞子。また、活
力の源と言われている人参。この製品は体
内のバランスを整え、健康の維持に最適な
ものとなっています。慢性的に体調が優れ
ないと感じている方、イキイキとした毎日
を送りたい方にお薦めします。



販売元

ANC (株)
福岡県大野城市下大利1-6-29
代表番号TEL:(0925)86-8028
<http://a-n-c.jp>

製造元

順天堂製薬株式会社 台中工場
台湾台中市工業区42路16号
<http://www.sunten.com.tw>



ANC

Asian Network Co., Ltd.

My choice is SEIRIN

What's yours?

For painless acupuncture treatments

I always trust Seirin.

New patients are surprised by its comfort, and my
regular clients ask for it by name.

Exceptional Products.

Join the thousands of distinguished professionals
who have counted on SEIRIN for over 30 years to provide
the highest quality needles for you,
and a painless experience for your clients.



Seirin Corporation
1007-1 Sodeshicho, Shimizu-ku, Shizuoka City, Shizuoka 424-0037, Japan
<http://www.seirin.jp> +81-3-3276-1821